

Property Name	RESIDIA YUTENJI	Unit No.	TYPE	Access	Yuutennji Station on Toyoko Line (5 min)
		208	Apt.		
Address	5-27-18, Nakameguro, Meguro-Ku, Tokyo				

## Stylish Residence in Yutenji / Nakameguro

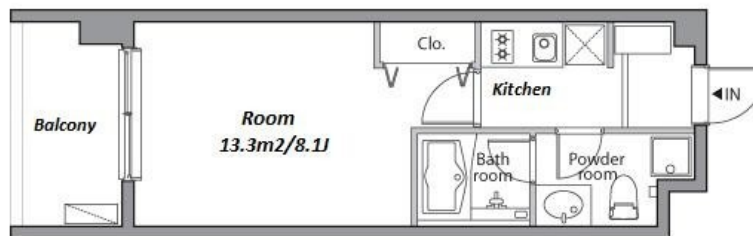

Lease Conditions	
LAYOUT	Studio
SIZE	24.99 m²/268.99 ft²
RENT	JPY 130,000 / month
Management Fee	JPY10,000/month
Deposit	2 months
Key Money	-
Lease Term	Standard lease for 24 months
Available	Now
Renewal Fee	1 month
Agent Fee	1 month + tax
Other Info	Key Replacement Fee : JPY18,000 Tax not included / Guarantor Company : TBC / No Key Money / Auto lock / Air-Con / Separated Toilet / Balcony / Internet (Extra Charge) / Penalty Fee for Early Cancellation / Flooring / Bathroom dryer

Building Information			
Completion	Sep, 2006	Earthquake Resistance	New
Structure	RC, 7 floors above		
Car Parking	TBC		
Bicycle Parking	TBC		
Music Instrument	-	Pet	Allowed
Facilities	Motorcycle Parking (extra charge) / Within 20 min to Roppongi by train / Near Large Parks / Delivery box / Elevator / Security / Close to Station		

Remarks
Tenant support fee: JPY.10,000+tax/2years Internet fee: JPY.1,500+tax/month / Pet:additional deposit ( 1 month ) / Pet : a small dog or a cat

\*The actual Layout & Size may differ slightly from this floor plans & pictures.



HOUSEREP TOKYO INC.

ハウスレップトーキョー株式会社

#301, 1-4-15, Hiroo, Shibuya-ku, Tokyo 150-0012, Japan

+81 (0)3 6427 5860

inquiry@housserrep-tokyo.com

Transaction Type : Intermediate

Agent Fee : 1 month + tax

Website : www.housserrep-tokyo.com

