

Property Name	TOMIGAYA SPRINGS	Unit No.	TYPE	Access	Yoyogihachimann Station on Odakyu Line (3 min) Yoyogikouenn Station on Chiyoda Line (3 min)
		406	Apt.		
Address	1-35-20, Tomigaya, Shibuya-Ku, Tokyo				

Apartment in Yoyogi, near Yoyogi Park

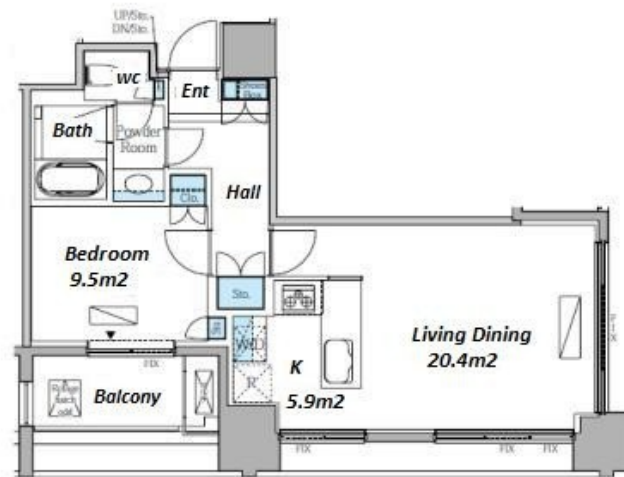

Lease Conditions

LAYOUT	1 BR		
SIZE	50.92 m²/548.09 ft²		
RENT	JPY 260,000 / month		
Management Fee	JPY10,000/month		
Deposit	2 months	Key Money	1 month
Lease Term	Standard lease for 24 months		
Available	End, Oct, 2024		
Renewal Fee	1 month		
Agent Fee	1 month + tax		
Other Info	Key Replacement Fee : JPY20,000 Tax not included / Guarantor Company : TBC / Auto lock / Air-Con / Separated Toilet / Balcony / Penalty Fee for Early Cancellation / Musical Instrument Negotiable / Flooring / Washer / Dryer / Bathroom dryer		

Building Information

Completion	Jan, 2011	Earthquake Resistance	New
Structure	RC, 17 floors above		
Car Parking	TBC		
Bicycle Parking	TBC		
Music Instrument	Negotiable	Pet	-
Facilities	Trunk Room (TBC) / Near Large Parks / Janitor / Delivery box / Elevator		

*The actual Layout & Size may differ slightly from this floor plans & pictures.



HOUSEREP TOKYO INC.

ハウズレップトーキョー株式会社

#301, 1-4-15, Hiroo, Shibuya-ku, Tokyo 150-0012, Japan

+81 (0)3 6427 5860 inquiry@housserrep-tokyo.com

Transaction Type : Intermediate

Agent Fee : 1 month + tax

Website : www.housserrep-tokyo.com



Remarks

Renters Insurance : Required