

Property Name	LA TOUR CHIYODA	Unit No.	TYPE	Access	Kudanshita Station on Tozai Line (5 min) Jinnbouchou Station on Hanzomon Line (6 min) Suidobashi Station on JR Chuo Line Rapid Service (6 min) Iidabashi Station on Yurakucho Line (11 min)
		2911	Apt.		
Address	3-5-3, Nishikanda, Chiyoda-Ku, Tokyo				

## High Rise Tower Residence in Iidabashi /Suidobashi Area

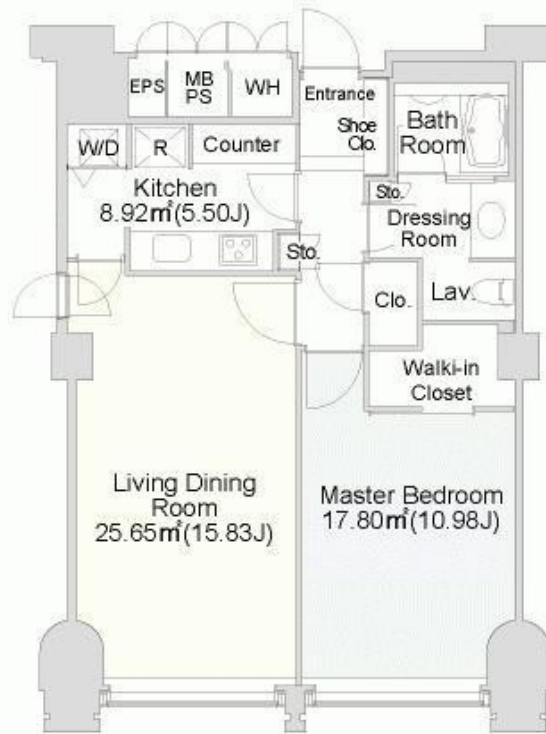

\*The actual Layout & Size may differ slightly from this floor plans & pictures.

Lease Conditions	
LAYOUT	1 BR
SIZE	71.41 m <sup>2</sup> /768.65 ft <sup>2</sup>
RENT	JPY 480,000 / month
Management Fee	-
Deposit	2 months
Key Money	-
Lease Term	Fixed term lease for 36 months
Available	Now
Renewal Fee	-
Agent Fee	1 month + tax
Other Info	Depreciation : 1 month / No Key Money / Auto lock / Fridge / Air-Con / Separated Toilet / Balcony / Internet Included / Penalty Fee for Early Cancellation / Flooring / Washer / Dryer / Oven / WIC

Building Information	
Completion	Jan, 2004
Earthquake Resistance	New
Structure	RC, 32 floors above and 2 basement floors
Car Parking	JPY40,000 ~ 70,000/ month
Bicycle Parking	TBC
Music Instrument	-
Pet	Negotiable
Facilities	Motorcycle Parking (TBC) / Trunk Room (TBC) / Gym (( Included )) / Within 20 min to Tokyo station by car / Near Large Parks / French Community / Front desk / Elevator / Close to Station / High-rise

Remarks



**HOUSEREP TOKYO INC.**

ハウスレップトーキョー株式会社

#301, 1-4-15, Hiroo, Shibuya-ku, Tokyo 150-0012, Japan

+81 (0)3 6427 5860

inquiry@housserrep-tokyo.com

Transaction Type : Intermediate

Agent Fee : 1 month + tax

Website : www.housserrep-tokyo.com

