

Property Name	RESIDIA SASAZUKA	Unit No.	TYPE	Access	Daitabashi Station on Keio Line (6 min) Sasaduka Station on Keio Line (8 min)
		103	Apt.		
Address	1-1-1, Honan, Suginami-Ku, Tokyo				

Low Rise Apt. in Suginami, near "Sasazuka" & "Daitabashi" stn.

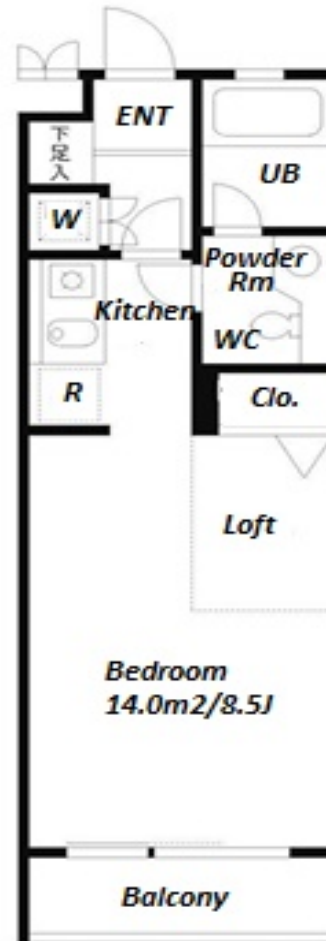

\*The actual Layout & Size may differ slightly from this floor plans & pictures.

Lease Conditions	
LAYOUT	Studio
SIZE	25.8 m <sup>2</sup> /277.7 ft <sup>2</sup>
RENT	JPY 108,000 / month
Management Fee	JPY10,000/month
Deposit	2 months
Key Money	-
Lease Term	Standard lease for 24 months
Available	End, Nov, 2024
Renewal Fee	1 month
Agent Fee	1 month + tax
Other Info	Key Replacement Fee : JPY17,000 Tax not included / Guarantor Company : TBC / No Key Money / Auto lock / Air-Con / Separated Toilet / Balcony / Loft/Maisonnette / Penalty Fee for Early Cancellation / Flooring / Bathroom dryer

Building Information			
Completion	Mar, 2000	Earthquake Resistance	New
Structure	RC, 6 floors above		
Car Parking	-		
Bicycle Parking	-		
Music Instrument	-	Pet	N/A
Facilities	Delivery box / Elevator / Security		

Remarks
Renters Insurance : Required / Tenant support fee: JPY.10,000+tax/2years



HOUSEREP TOKYO INC.

ハウスレップトーキョー株式会社

#301, 1-4-15, Hiroo, Shibuya-ku, Tokyo 150-0012, Japan

+81 (0)3 6427 5860

inquiry@housserrep-tokyo.com

Transaction Type : Intermediate

Agent Fee : 1 month + tax

Website : www.housserrep-tokyo.com

