

Property Name	PROUD EBISU MINAMI	Unit No.	TYPE	Access	Ebisu Station on Hibiya Line (2 min)
		1301	Apt.		
Address	1-11-10, Ebisuminami, Shibuya-Ku, Tokyo				

Luxury & Comfortable Apartment in Stylish "Ebisu" area Accessible to "Daikanyama" and

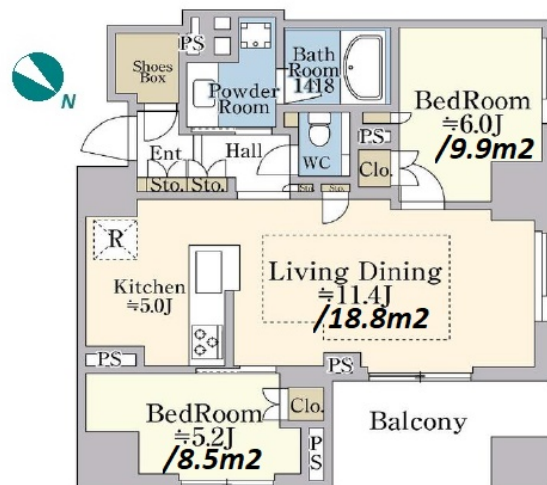
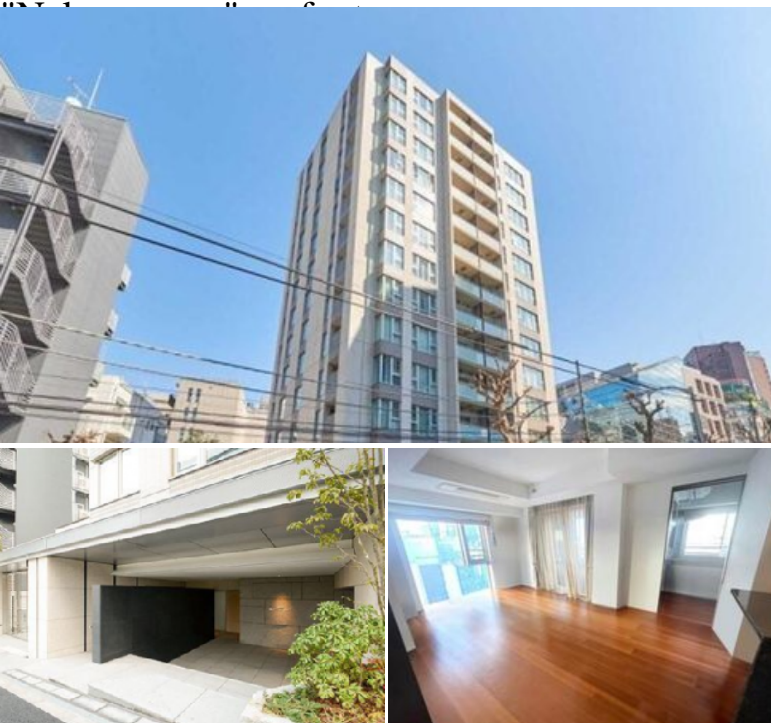

Lease Conditions	
LAYOUT	2 BR
SIZE	62.62 m²/674.03 ft²
RENT	JPY 550,000 / month
Management Fee	JPY20,000/month
Deposit	2 months
Key Money	1 month
Lease Term	Fixed term lease for 24 months
Available	End, Nov, 2024
Renewal Fee	-
Agent Fee	1 month + tax
Other Info	Key Replacement Fee : JPY45,000 Tax not included / Guarantor Company : TBC / Auto lock / Air-Con / Separated Toilet / Balcony / Penalty Fee for Early Cancellation / Flooring / Floor Heating / Dishwasher / Bathroom dryer

Building Information	
Completion	Nov, 2016
Earthquake Resistance	New
Structure	RC, 13 floors above and 1 basement floors
Car Parking	TBC
Bicycle Parking	JPY200 ~ 400 + tax / month
Music Instrument	-
Pet	-
Facilities	Motorcycle Parking (JPY4,000 + tax / month) / Within 20 min to Roppongi by train / Near Large Parks / Elevator / 24h Garbage Drop-off

Remarks
Renters Insurance : Required

*The actual Layout & Size may differ slightly from this floor plans & pictures.



HOUSEREP TOKYO INC.

ハウスレップトキョー株式会社

#301, 1-4-15, Hiroo, Shibuya-ku, Tokyo 150-0012, Japan

+81 (0)3 6427 5860

inquiry@housserep-tokyo.com

Transaction Type : Intermediate

Agent Fee : 1 month + tax

Website : www.housserep-tokyo.com

