

Property Name	NISHI SHINJUKU FOREST ANNEX	Unit No.	TYPE	Access	Tochoumae Station on Oedo Line (8 min) Hatsudai Station on Keio Line (10 min)
		404	Apt.		
Address	4-32-13, Nishishinjuku, Shinjuku-Ku, Tokyo				

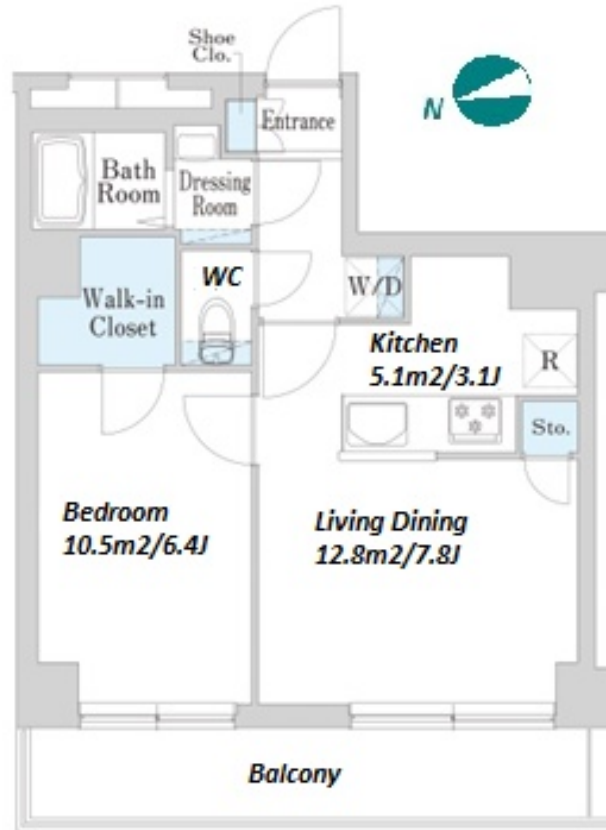

Lease Conditions

LAYOUT	1 BR		
SIZE	41.22 m ² /443.68 ft ²		
RENT	JPY 172,000 / month		
Management Fee	-		
Deposit	2 months	Key Money	-
Lease Term	Fixed term lease for 36 months		
Available	Negotiable		
Renewal Fee	-		
Agent Fee	1 month + tax		
Other Info	Depreciation : 1 month / No Key Money / Air-Con / Separated Toilet / Balcony / Penalty Fee for Early Cancellation / WIC		

Building Information

Completion	Aug, 1990	Earthquake Resistance	New
Structure	RC, 7 floors above		
Car Parking	-		
Bicycle Parking	extra charge		
Music Instrument	-	Pet	N/A
Facilities	Motorcycle Parking (extra charge) / Delivery box / Elevator		

Remarks

Renters Insurance : Required

*The actual Layout & Size may differ slightly from this floor plans & pictures.



HOUSEREP TOKYO INC.

ハウスレップトーキョー株式会社

#301, 1-4-15, Hiroo, Shibuya-ku, Tokyo 150-0012, Japan

+81 (0)3 6427 5860

inquiry@housserep-tokyo.com

Transaction Type : Intermediate

Agent Fee : 1 month + tax

Website : www.housserep-tokyo.com

