

Property Name	TERRACE SANEICHO	Unit No.	TYPE	Access	Yotsuya Station on JR Chuo Line (8 min) Yotsuyasannchoume Station on Marunouchi Line (9 min)
		B	Apt.		
Address	13-6, Yotsuyasaneicho, Shinjuku-Ku, Tokyo				

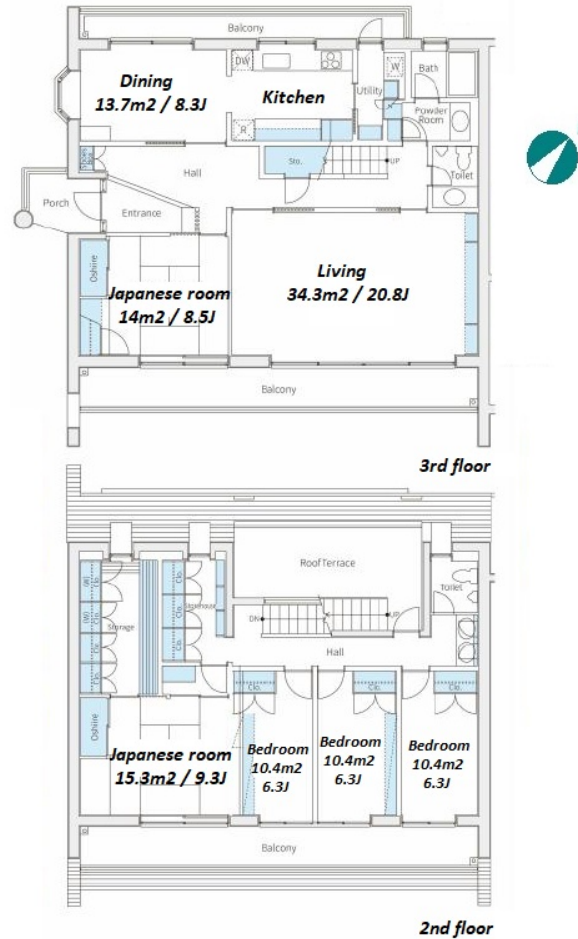

\*The actual Layout & Size may differ slightly from this floor plans & pictures.

Lease Conditions	
LAYOUT	3 BR
SIZE	196.19 m <sup>2</sup> /2111.77 ft <sup>2</sup>
RENT	JPY 750,000 / month
Management Fee	-
Deposit	2 months
Key Money	1 month
Lease Term	Standard lease for 24 months
Available	End, Dec, 2024
Renewal Fee	1 month
Agent Fee	1 month + tax
Other Info	Key Replacement Fee : JPY20,000 Tax not included / Air-Con / Balcony / Loft/Maisonnette / Internet (Extra Charge) / Roof Balcony / Flooring / Dishwasher / Oven / 2 Toilets

Building Information			
Completion	Jul, 1988	Earthquake Resistance	New
Structure	RC, 3 floors above and 1 basement floors		
Car Parking	for 3 spaces ( Included )		
Bicycle Parking	-		
Music Instrument	-	Pet	Allowed
Facilities	Low-rise		

Remarks
Renters Insurance : Required / Pet:additional deposit ( 1 month )



HOUSEREP TOKYO INC.

ハウズレップトーキョー株式会社

#301, 1-4-15, Hiroo, Shibuya-ku, Tokyo 150-0012, Japan

+81 (0)3 6427 5860

inquiry@housserrep-tokyo.com

Transaction Type : Intermediate

Agent Fee : 1 month + tax

Website : www.housserrep-tokyo.com

