

Property Name	NIHONBASHI HAKOZAKI CITY HEIGHTS	Unit No.	TYPE	Access	Suitennguumae Station on Hanzomon Line (2 min) Kayabachou Station on Tozai Line (8 min) Ninngyouchou Station on Hibiya Line (9 min)
		303	Apt.		
Address	26-1, Nihombashihakozakicho, Chuo-Ku, Tokyo				

Mid-rise Apt. near Nihonbashi

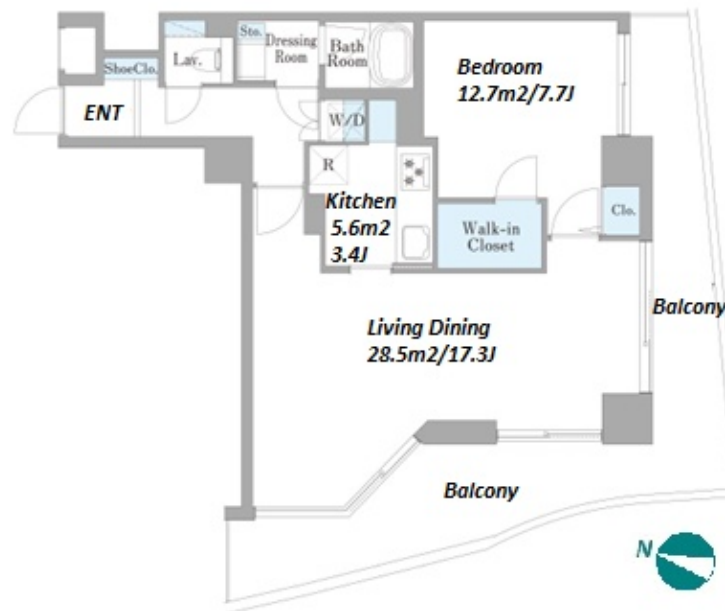

Lease Conditions		
LAYOUT	1 BR	
SIZE	63.93 m ² /688.13 ft ²	
RENT	JPY 280,000 / month	
Management Fee	JPY 15,000/month	
Deposit	2 months	Key Money -
Lease Term	Fixed term lease for 36 months	
Available	Now	
Renewal Fee	-	
Agent Fee	1 month + tax	
Other Info	Depreciation : 1 month / No Key Money / Auto lock / Renovated / Air-Con / Separated Toilet / Balcony / Penalty Fee for Early Cancellation / Musical Instrument Negotiable / Flooring / WIC	

Building Information		
Completion	Apr, 1996	Earthquake Resistance New
Structure	SRC, 14 floors above and 1 basement floors	
Car Parking	JPY30,000 ~ 65,000/ month	
Bicycle Parking	extra charge	
Music Instrument	Negotiable	Pet N/A
Facilities	Delivery box / Elevator	

Remarks
Renters Insurance : Required

*The actual Layout & Size may differ slightly from this floor plans & pictures.



HOUSEREP TOKYO INC.

ハウスレップトーキョー株式会社

#301, 1-4-15, Hiroo, Shibuya-ku, Tokyo 150-0012, Japan

+81 (0)3 6427 5860

inquiry@housserep-tokyo.com

Transaction Type : Intermediate

Agent Fee : 1 month + tax

Website : www.housserep-tokyo.com

