

Property Name	RESIDIA MITSUKOSHIMAE	Unit No.	TYPE	Access	Shinnihonbashi Station on JR Sobu Line (2 min) Kodenmachou Station on Hibiya Line (4 min) Mitsukoshimae Station on Ginza Line (6 min)
		808	Apt.		
Address	3-6-7, Nihombashihoncho, Chuo-Ku, Tokyo				

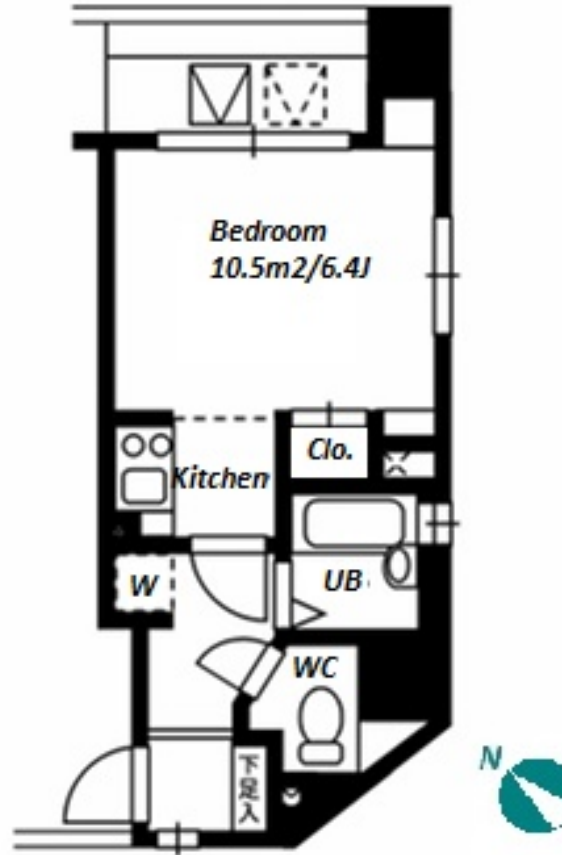

Lease Conditions	
LAYOUT	Studio
SIZE	21.06 m²/226.68 ft²
RENT	JPY 102,000 / month
Management Fee	JPY 10,000/month
Deposit	2 months
Key Money	-
Lease Term	Standard lease for 24 months
Available	Now
Renewal Fee	1 month
Agent Fee	1 month + tax
Other Info	Key Replacement Fee : JPY 19,500 Tax not included / Guarantor Company : TBC / No Key Money / Auto lock / Air-Con / Separated Toilet / Balcony / Penalty Fee for Early Cancellation / CS/CATV / Flooring / Bathroom dryer

Building Information			
Completion	Feb, 2005	Earthquake Resistance	New
Structure	SRC, 15 floors above		
Car Parking	-		
Bicycle Parking	-		
Music Instrument	-	Pet	N/A
Facilities	Within 20 min to Tokyo station by car / Delivery box / Elevator / Security / Close to Station / 24h Garbage Drop-off / High-rise		

Remarks
Renters Insurance : Required / Tenant support fee: JPY.10,000+tax/2years

*The actual Layout & Size may differ slightly from this floor plans & pictures.



HOUSEREP TOKYO INC.

ハウスレップトーキョー株式会社

#301, 1-4-15, Hiroo, Shibuya-ku, Tokyo 150-0012, Japan

+81 (0)3 6427 5860

inquiry@housserep-tokyo.com

Transaction Type : Intermediate

Agent Fee : 1 month + tax

Website : www.housserep-tokyo.com

