

Property Name	OIMACHI HEIGHTS	Unit No.	TYPE	Access	Ooimachi Station on JR Keihin Tohoku Line (3 min) Ooimachi Station on Rinkai Line (4 min) Ooimachi Station on Ooimachi Line (4 min)
		1209	Apt.		
Address	1-28-1, Oi, Shinagawa-Ku, Tokyo				

Mid-rise Residence in Oimachi, near Osaki area

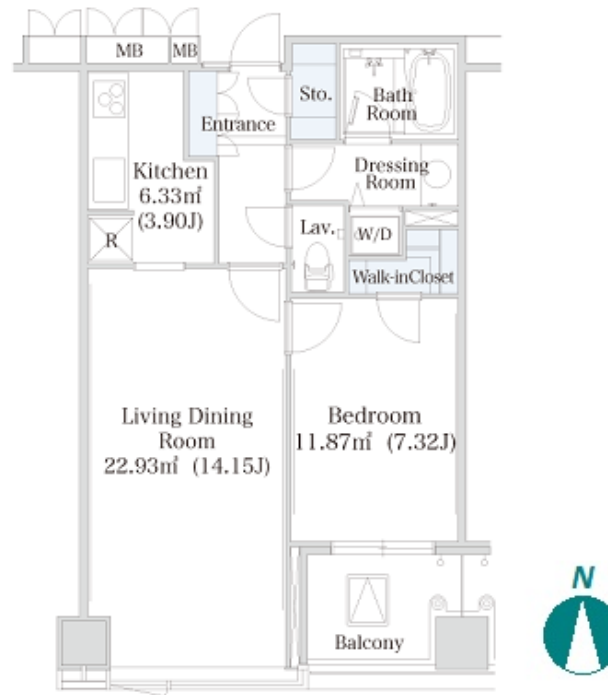

Lease Conditions		
LAYOUT	1 BR	
SIZE	58.2 m²/626.45 ft²	
RENT	JPY 289,000 / month	
Management Fee	-	
Deposit	2 months	Key Money -
Lease Term	Fixed term lease for 36 months	
Available	Negotiable	
Renewal Fee	-	
Agent Fee	1 month + tax	
Other Info	Depreciation : 1 month / No Key Money / Auto lock / Air-Con / Separated Toilet / Balcony / Internet Included / Penalty Fee for Early Cancellation / Bathroom dryer / WIC	

Building Information			
Completion	Sep, 2002	Earthquake Resistance	New
Structure	SRC, 14 floors above and 2 basement floors		
Car Parking	TBC		
Bicycle Parking	TBC		
Music Instrument	-	Pet	N/A
Facilities	Motorcycle Parking (TBC) / Near Large Parks / Delivery box / Elevator		

Remarks

\*The actual Layout & Size may differ slightly from this floor plans & pictures.



HOUSEREP TOKYO INC.

ハウスレップトーキョー株式会社

#301, 1-4-15, Hiroo, Shibuya-ku, Tokyo 150-0012, Japan

+81 (0)3 6427 5860 inquiry@housserrep-tokyo.com

Transaction Type : Intermediate

Agent Fee : 1 month + tax

Website : www.housserrep-tokyo.com

