

Property Name	OSAKI GARDEN RESIDENCE	Unit No.	TYPE	Access	Oosaki Station on JR Yamanote Line (8 min) Ooimachi Station on JR Keihin Tohoku Line (15 min) Gotanda Station on JR Yamanote Line (18 min)
		1211	Apt.		
Address	1-2-1, Nishishinagawa, Shinagawa-Ku, Tokyo				

Modern High-rise Apt. in Osaki, easy access to Ebisu / Shibuya / Yokohama.

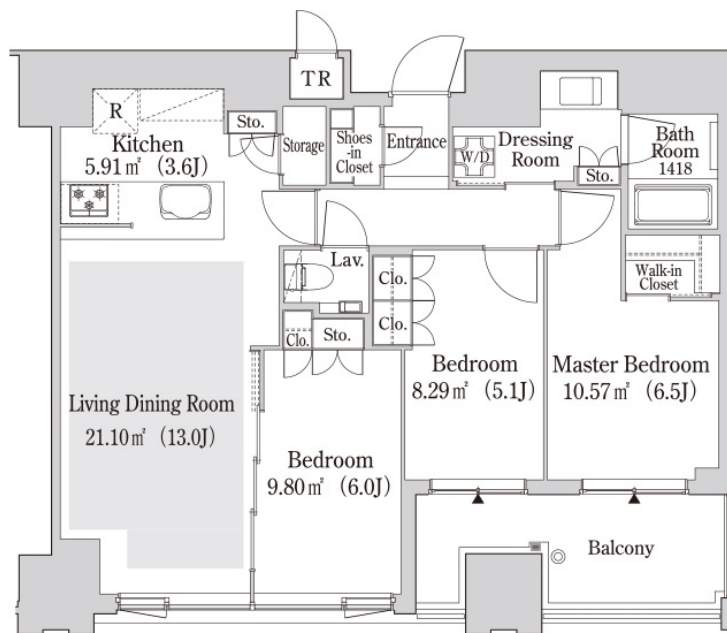

Lease Conditions	
LAYOUT	3 BR
SIZE	76.65 m²/825.05 ft²
RENT	JPY 399,000 / month
Management Fee	-
Deposit	2 months
Key Money	-
Lease Term	Fixed term lease for 36 months
Available	Negotiable
Renewal Fee	-
Agent Fee	1 month + tax
Other Info	Depreciation : 1 month / No Key Money / Auto lock / Air-Con / Separated Toilet / Balcony / Penalty Fee for Early Cancellation / Flooring / Floor Heating / Bathroom dryer / WIC

Building Information			
Completion	Aug, 2018	Earthquake Resistance	New
Structure	RC, 23 floors above and 1 basement floors		
Car Parking	TBC		
Bicycle Parking	TBC		
Music Instrument	-	Pet	Allowed
Facilities	Motorcycle Parking (TBC) / Within 20 min to Tokyo station by car / Near Large Parks / Front desk / Concierge / Janitor / Delivery box / Elevator / High-rise / Newly-built (~7 y/o)		

Remarks
Renters Insurance : Required / Pet:additional deposit (1 month)

*The actual Layout & Size may differ slightly from this floor plans & pictures.



HOUSEREP TOKYO INC.

ハウスレップトーキョー株式会社

#301, 1-4-15, Hiroo, Shibuya-ku, Tokyo 150-0012, Japan

+81 (0)3 6427 5860

inquiry@housserrep-tokyo.com

Transaction Type : Intermediate

Agent Fee : 1 month + tax

Website : www.housserrep-tokyo.com

