

Property Name	OSAKI GARDEN RESIDENCE	Unit No.	TYPE	Access	Oosaki Station on JR Yamanote Line (8 min) Ooimachi Station on JR Keihin Tohoku Line (15 min) Gotanda Station on JR Yamanote Line (18 min)
		105	Apt.		
Address	1-2-1, Nishishinagawa, Shinagawa-Ku, Tokyo				

Modern High-rise Apt. in Osaki, easy access to Ebisu / Shibuya / Yokohama.

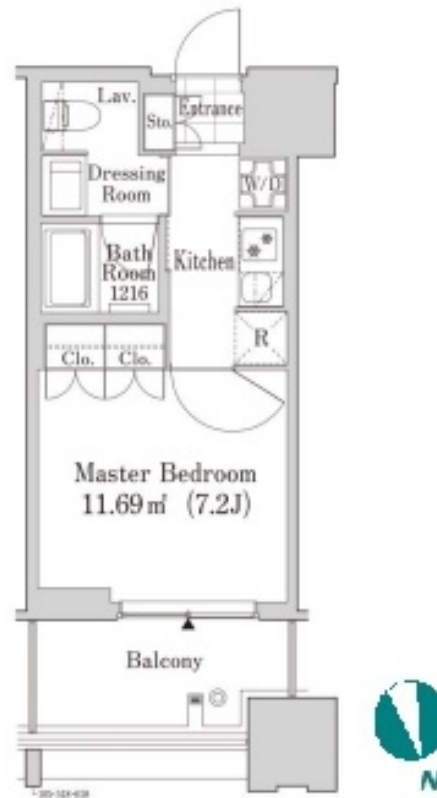

Lease Conditions		
LAYOUT	Studio	
SIZE	25.15 m²/270.71 ft²	
RENT	JPY 133,000 / month	
Management Fee	-	
Deposit	2 months	Key Money -
Lease Term	Fixed term lease for 36 months	
Available	Negotiable	
Renewal Fee	-	
Agent Fee	1 month + tax	
Other Info	Depreciation : 1 month / No Key Money / Auto lock / Air-Con / Separated Toilet / Balcony / Penalty Fee for Early Cancellation / Flooring / Bathroom dryer	

Building Information			
Completion	Aug, 2018	Earthquake Resistance	New
Structure	RC, 23 floors above and 1 basement floors		
Car Parking	TBC		
Bicycle Parking	TBC		
Music Instrument	-	Pet	Allowed
Facilities	Motorcycle Parking (TBC) / Within 20 min to Tokyo station by car / Near Large Parks / Front desk / Concierge / Janitor / Delivery box / Elevator / High-rise / Newly-built (~7 y/o)		

Remarks
Pet:additional deposit (1 month)

*The actual Layout & Size may differ slightly from this floor plans & pictures.



HOUSEREP TOKYO INC.

ハウスレップトーキョー株式会社

#301, 1-4-15, Hiroo, Shibuya-ku, Tokyo 150-0012, Japan

+81 (0)3 6427 5860 inquiry@housserrep-tokyo.com

Transaction Type : Intermediate

Agent Fee : 1 month + tax

Website : www.housserrep-tokyo.com

