

Property Name	MIREA COURT GINZA PREMIER	Unit No.	TYPE	Access	Higashiginza Station on Hibiya Line (1 min) Ginnza Station on Ginza Line (4 min)
		805	Apt.		
Address	3-12-12, Ginza, Chuo-Ku, Tokyo				

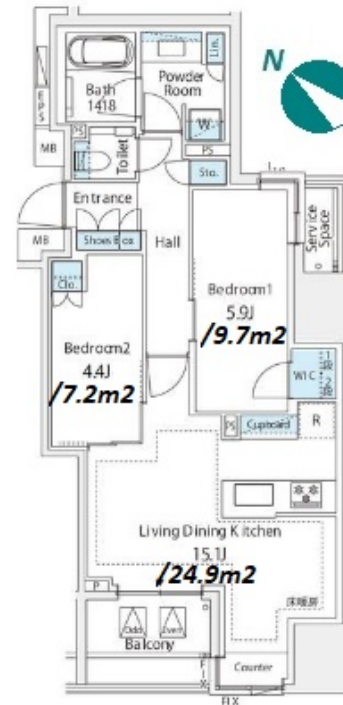

Lease Conditions

LAYOUT	2 BR	
SIZE	62.01 m ² /667.47 ft ²	
RENT	JPY 434,000 / month	
Management Fee	JPY20,000/month	
Deposit	2 months	Key Money -
Lease Term	Standard lease for 24 months	
Available	Now	
Renewal Fee	1 month	
Agent Fee	1 month + tax	
Other Info	Key Replacement Fee : JPY20,000 Tax not included / Guarantor Company : TBC / Auto lock / Air-Con / Separated Toilet / Balcony / Flooring / Floor Heating / Dishwasher / Bathroom dryer / WIC	

Building Information

Completion	Mar, 2018	Earthquake Resistance	New
Structure	RC, 13 floors above and 1 basement floors		
Car Parking	N/A		
Bicycle Parking	for 1 space (Included)		
Music Instrument	-	Pet	Negotiable
Facilities	Within 20 min to Tokyo station by car / Janitor / Delivery box / Elevator / Close to Station / 24h Garbage Drop-off / Newly-built (~7 y/o)		

Remarks

Renters Insurance : Required

*The actual Layout & Size may differ slightly from this floor plans & pictures.



HOUSEREP TOKYO INC.

ハウスレップトーキョー株式会社

#301, 1-4-15, Hiroo, Shibuya-ku, Tokyo 150-0012, Japan

+81 (0)3 6427 5860

inquiry@housserrep-tokyo.com

Transaction Type : Intermediate

Agent Fee : 1 month + tax

Website : www.housserrep-tokyo.com

