

Property Name	KUDAN SILVER PALACE	Unit No.	TYPE	Access	Ichigaya Station on Toei Shinjuku Line (2 min) Ichigaya Station on JR Chuo-Sobu Line (5 min) Hannzoumonn Station on Hanzomon Line (10 min)
		7F	Apt.		
Address	4-6-1, Kudamminami, Chiyoda-Ku, Tokyo				

Vintage Apartment close to "Yasukuni Shrine" & "Imperial Garden" Easy Access to "Ichigaya"

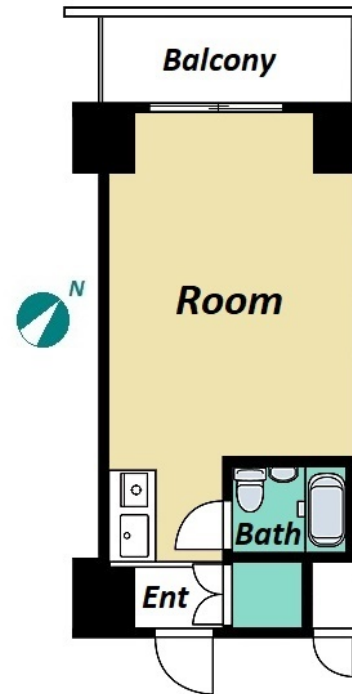

Lease Conditions			
LAYOUT	Studio		
SIZE	26.6 m ² /286.32 ft ²		
RENT	JPY 99,000 / month		
Management Fee	JPY6,000/month		
Deposit	1 month	Key Money	1 month
Lease Term	Standard lease for 24 months		
Available	Negotiable		
Renewal Fee	1 month		
Agent Fee	1 month + tax		
Other Info	Auto lock / Renovated / Air-Con / Balcony / Internet (Extra Charge) / SOHO Allowed / Penalty Fee for Early Cancellation / IH Stoves / Corner Unit		

Building Information			
Completion	Aug, 1985	Earthquake Resistance	New
Structure	SRC, 10 floors above and 1 basement floors		
Car Parking	N/A		
Bicycle Parking	extra charge		
Music Instrument	-	Pet	-
Facilities	Within 20 min to Tokyo station by car / Near Large Parks / Janitor / Delivery box / Elevator / Security / Close to Station		

Remarks
Renters Insurance : Required

*The actual Layout & Size may differ slightly from this floor plans & pictures.



HOUSEREP TOKYO INC.

ハウズレップトーキョー株式会社

#301, 1-4-15, Hiroo, Shibuya-ku, Tokyo 150-0012, Japan

+81 (0)3 6427 5860

inquiry@housserrep-tokyo.com

Transaction Type : Intermediate

Agent Fee : 1 month + tax

Website : www.housserrep-tokyo.com

