

Property Name	BRILLIA GRANDE MINATOMIRAI PARK FRONT TOWER	Unit No.	TYPE	Access	Minatomirai Station on Minatomirai Line (6 min) Shinntakashima Station on Minatomirai Line (7 min) Yokohama Station on JR Tokaido Line (13 min)
		705	Apt.		
Address	5-3-1, Minatomirai, Nishi-Ku, Yokohama-Shi, Kanagawa				

Luxury Tower Residence w/ Amenities in Minato-Mirai, next "a Kid's Park"

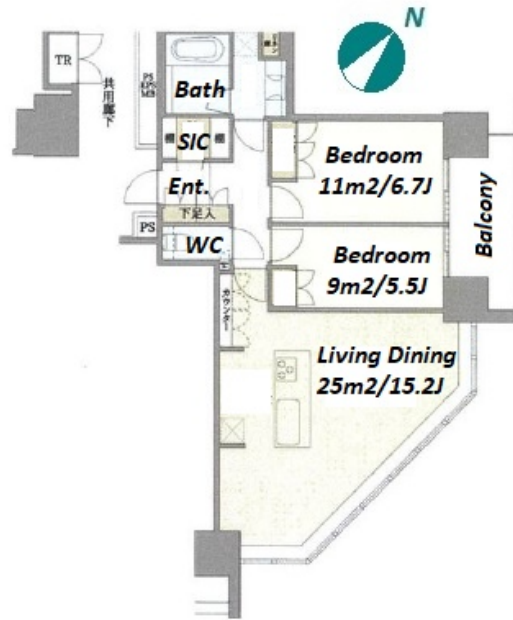

Lease Conditions	
LAYOUT	2 BR
SIZE	71.46 m²/769.18 ft²
RENT	JPY 290,000 / month
Management Fee	JPY10,000/month
Deposit	2 months
Key Money	1 month
Lease Term	Standard lease for 24 months
Available	Now
Renewal Fee	1 month
Agent Fee	1 month + tax
Other Info	Guarantor Company : TBC / Auto lock / Air-Con / Separated Toilet / Balcony / Internet Included / Flooring / Floor Heating / Dishwasher / Bathroom dryer

Building Information	
Completion	Nov, 2007
Earthquake Resistance	New
Structure	RC, 30 floors above and 1 basement floors
Car Parking	JPY30,000 + tax / month
Bicycle Parking	JPY800 ~ 1,000/ month
Music Instrument	-
Pet	N/A
Facilities	Motorcycle Parking (JPY150 ~ 300/ month) / Trunk Room (TBC)

Remarks
Renters Insurance : Required

*The actual Layout & Size may differ slightly from this floor plans & pictures.



HOUSEREP TOKYO INC.

ハウスレップトーキョー株式会社

#301, 1-4-15, Hiroo, Shibuya-ku, Tokyo 150-0012, Japan

+81 (0)3 6427 5860

inquiry@housserep-tokyo.com

Transaction Type : Intermediate

Agent Fee : 1 month + tax

Website : www.housserep-tokyo.com

