

Property Name	RESIDIA KAMIMEGURO	Unit No.	TYPE	Access	Nakameguro Station on Toyoko Line (12 min)
		402	Apt.		
Address	5-6-2, Kamimeguro, Meguro-Ku, Tokyo				

Renovated Low-Rise Apt. in Meguro near "Meguro River"

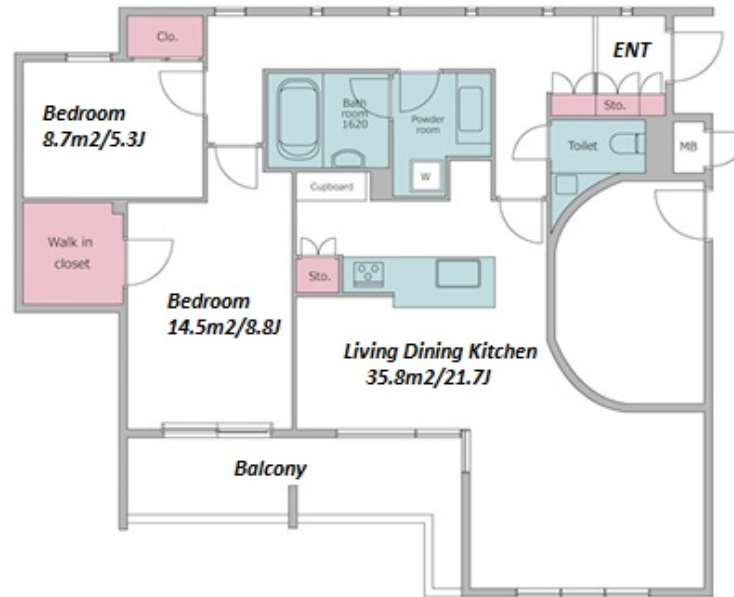

Lease Conditions	
LAYOUT	2 BR
SIZE	89.9 m²/967.67 ft²
RENT	JPY 475,000 / month
Management Fee	JPY15,000/month
Deposit	2 months
Key Money	1 month
Lease Term	Standard lease for 24 months
Available	Early, Oct, 2024
Renewal Fee	1 month
Agent Fee	1 month + tax
Other Info	Key Replacement Fee : JPY18,000 Tax not included / Auto lock / Renovated / Air-Con / Separated Toilet / Balcony / Internet (Extra Charge) / Penalty Fee for Early Cancellation / Flooring / Bathroom dryer / WIC

Building Information	
Completion	Feb, 1993
Earthquake Resistance	New
Structure	RC, 5 floors above
Car Parking	JPY35,000 ~ 50,000 + tax / month
Bicycle Parking	-
Music Instrument	-
Pet	Allowed
Facilities	Within 20 min to Roppongi by train / Near Large Parks / Delivery box / Elevator / Security / Low-rise

Remarks
Renters Insurance : Required / Tenant membership service fee: JPY.10,000+tax/2 years Internet subscription fee: JPY.1,500+tax/month / Parking : 1 month deposit / Pet:additional deposit (1 month)

*The actual Layout & Size may differ slightly from this floor plans & pictures.



HOUSEREP TOKYO INC.

ハウスレップトーキョー株式会社

#301, 1-4-15, Hiroo, Shibuya-ku, Tokyo 150-0012, Japan

+81 (0)3 6427 5860

inquiry@housserrep-tokyo.com

Transaction Type : Intermediate

Agent Fee : 1 month + tax

Website : www.housserrep-tokyo.com

