

Property Name	RESIDIA MINAMISENJU	Unit No.	TYPE	Access	Minamisennju Station on Hibiya Line (9 min) Minamisennju Station on JR Joban Line (9 min) Minamisennju Station on (9 min)
		1101	Apt.		
Address	3-41-6, Minamisenju, Arakawa-Ku, Tokyo				

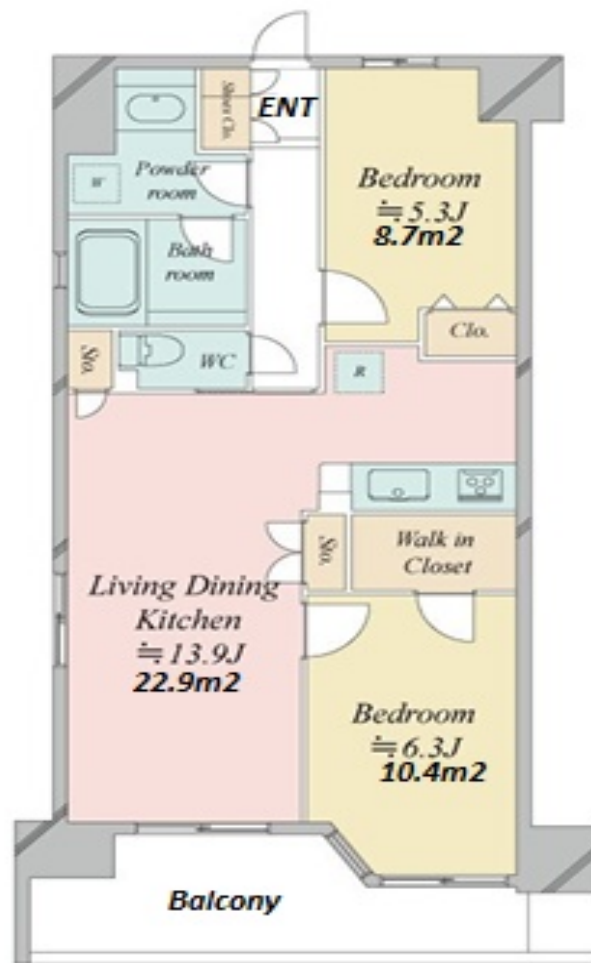

\*The actual Layout & Size may differ slightly from this floor plans & pictures.

Lease Conditions	
LAYOUT	2 BR
SIZE	59.68 m <sup>2</sup> /642.39 ft <sup>2</sup>
RENT	JPY 175,000 / month
Management Fee	JPY15,000/month
Deposit	2 months
Key Money	1 month
Lease Term	Fixed term lease for 36 months
Available	Now
Renewal Fee	-
Agent Fee	1 month + tax
Other Info	Key Replacement Fee : JPY18,000 Tax not included / Guarantor Company : TBC / Auto lock / Air-Con / Separated Toilet / Balcony / Internet (Extra Charge) / Penalty Fee for Early Cancellation / Nice Views / Flooring / Bathroom dryer / WIC / Corner Unit

Building Information			
Completion	Mar, 2007	Earthquake Resistance	New
Structure	RC, 11 floors above		
Car Parking	JPY18,000 + tax / month		
Bicycle Parking	TBC		
Music Instrument	-	Pet	N/A
Facilities	Motorcycle Parking (JPY3,000 + tax / month) / Delivery box / Elevator		

Remarks
Renters Insurance : Required / Internet fee: JPY.1,500+tax/month



HOUSEREP TOKYO INC.

ハウスレップトーキョー株式会社

#301, 1-4-15, Hiroo, Shibuya-ku, Tokyo 150-0012, Japan

+81 (0)3 6427 5860

inquiry@housserrep-tokyo.com

Transaction Type : Intermediate

Agent Fee : 1 month + tax

Website : www.housserrep-tokyo.com

