

Property Name	PARK CUBE NISHI-SHINJUKU	Unit No.	TYPE	Access	Ookubo Station on JR Chuo Line Rapid Service (4 min) Nishishinjuku Station on Marunouchi Line (7 min) Shinjuku Station on JR Yamanote Line (11 min)
		305	Apt.		
Address	1-2-6, Kitashinjuku, Shinjuku-Ku, Tokyo				

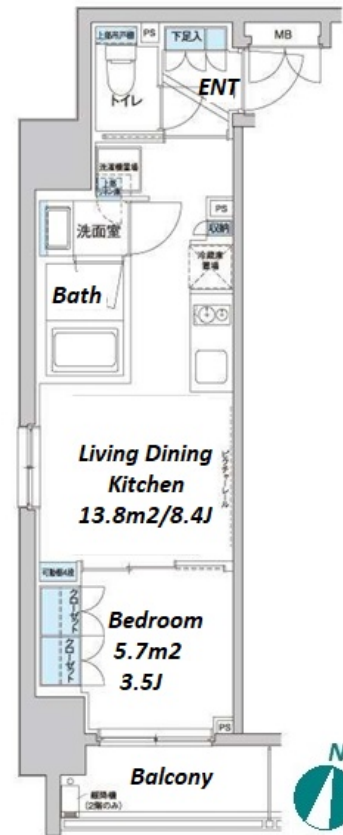
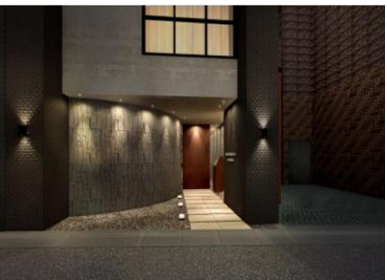

Lease Conditions	
LAYOUT	1 BR
SIZE	29.28 m <sup>2</sup> /315.16 ft <sup>2</sup>
RENT	JPY 145,000 / month
Management Fee	JPY 12,000/month
Deposit	1 month
Key Money	-
Lease Term	Standard lease for 24 months
Available	Early, Oct, 2024
Renewal Fee	1 month
Agent Fee	1 month + tax
Other Info	Key Replacement Fee : JPY 15,000 Tax not included / Auto lock / Air-Con / Penalty Fee for Early Cancellation / CS/CATV / Flooring / Floor Heating / Bathroom dryer

Building Information			
Completion	Jan, 2015	Earthquake Resistance	New
Structure	RC, 13 floors above		
Car Parking	N/A		
Bicycle Parking	for 1 space ( Included )		
Music Instrument	-	Pet	N/A
Facilities	Janitor / Delivery box / Elevator / Close to Station		

Remarks
Renters Insurance : Required

\*The actual Layout & Size may differ slightly from this floor plans & pictures.



HOUSEREP TOKYO INC.

ハウズレップトーキョー株式会社

#301, 1-4-15, Hiroo, Shibuya-ku, Tokyo 150-0012, Japan

+81 (0)3 6427 5860

inquiry@housserep-tokyo.com

Transaction Type : Intermediate

Agent Fee : 1 month + tax

Website : www.housserep-tokyo.com

