

Property Name	COMFORIA TOYOSU	Unit No.	TYPE	Access	Toyosu Station on Yurakucho Line (9 min)
		506	Apt.		
Address	1-4-12, Edagawa, Koto-Ku, Tokyo				

## Stylish Apt. in Toyosu

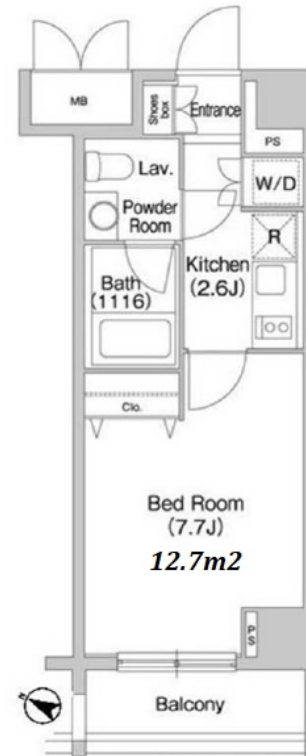

Lease Conditions		
LAYOUT	Studio	
SIZE	25.92 m <sup>2</sup> /279 ft <sup>2</sup>	
RENT	JPY 107,000 / month	
Management Fee	JPY8,000/month	
Deposit	2 months	Key Money -
Lease Term	Standard lease for 24 months	
Available	Early, Nov, 2024	
Renewal Fee	1 month	
Agent Fee	1 month + tax	
Other Info	Key Replacement Fee : JPY30,000 Tax not included / Guarantor Company : TBC / No Key Money / Free rent / Auto lock / Air-Con / Separated Toilet / Balcony / Penalty Fee for Early Cancellation / Roof Balcony / Flooring / Bathroom dryer	

Building Information			
Completion	Mar, 2009	Earthquake Resistance	New
Structure	RC, 9 floors above		
Car Parking	N/A		
Bicycle Parking	extra charge		
Music Instrument	-	Pet	Allowed
Facilities	Motorcycle Parking (extra charge) / Within 20 min to Tokyo station by car / Near Large Parks / Delivery box / Elevator		

\*The actual Layout & Size may differ slightly from this floor plans & pictures.



HOUSEREP TOKYO INC.

ハウズレップトーキョー株式会社

#301, 1-4-15, Hiroo, Shibuya-ku, Tokyo 150-0012, Japan

+81 (0)3 6427 5860

inquiry@housserrep-tokyo.com

Transaction Type : Intermediate

Agent Fee : 1 month + tax

Website : www.housserrep-tokyo.com



Remarks
Bicycle parking : Registration fee: JPY1,000+tax / Pet:additional deposit ( 1 month ) / Pet : a small dog or up to two cats