

Property Name	PARK COURT TORANOMON ATAGO TOWER	Unit No.	TYPE	Access
		2106	Apt.	
Address	3-14-1, Toranomom, Minato-Ku, Tokyo			
Kamiyachou Station on Hibiya Line (4 min) Onarimonn Station on Mita Line (8 min) Toranomonn Station on Ginza Line (9 min)				

High rise apartment in TOKYO near Kamiyacho Sta.

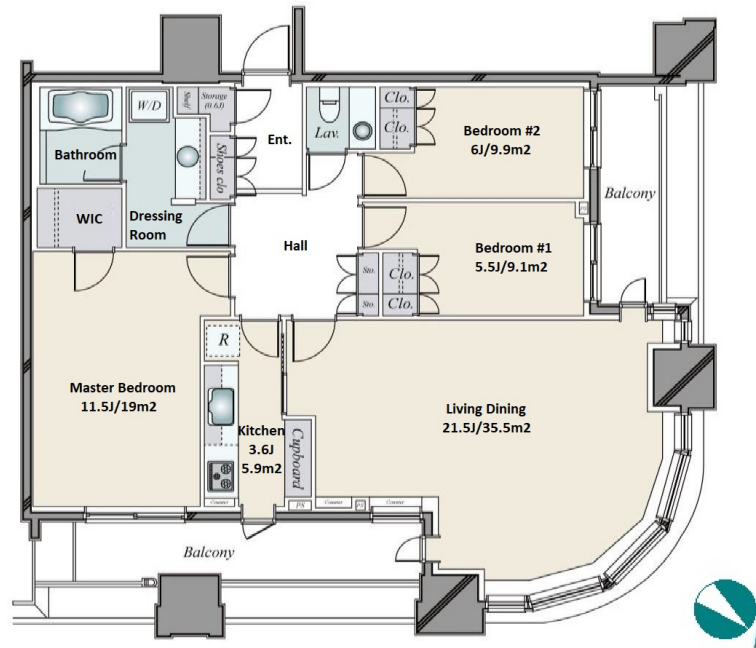

Lease Conditions		
LAYOUT	3 BR	
SIZE	108.97 m ² /1172.94 ft ²	
RENT	JPY 720,000 / month	
Management Fee	-	
Deposit	3 months	Key Money 1 month
Lease Term	Fixed term lease for 36 months	
Available	Negotiable	
Renewal Fee	-	
Agent Fee	1 month + tax	
Other Info	Guarantor Company : TBC / Auto lock / Air-Con / Separated Toilet / Balcony / Penalty Fee for Early Cancellation / Nice Views / Flooring / Floor Heating / Dishwasher / Bathroom dryer / WIC / Corner Unit	

Building Information		
Completion	Apr, 2008	Earthquake Resistance New
Structure	RC, 30 floors above	
Car Parking	TBC	
Bicycle Parking	TBC	
Music Instrument	-	Pet N/A
Facilities	Within 20 min to Roppongi by train / Janitor / Delivery box / Elevator / Security / Close to Station / High-rise	

*The actual Layout & Size may differ slightly from this floor plans & pictures.



HOUSEREP TOKYO INC.

ハウスレップトーキョー株式会社

#301, 1-4-15, Hiroo, Shibuya-ku, Tokyo 150-0012, Japan

+81 (0)3 6427 5860 inquiry@housserep-tokyo.com

Transaction Type : Intermediate

Agent Fee : 1 month + tax

Website : www.housserep-tokyo.com



Remarks
Fixed term lease : Key replacement fee: *TBC / Renters Insurance : Required