

Property Name	PARK TOWER KACHIDOKI SOUTH	Unit No.	TYPE	Access	Kachidoki Station on Oedo Line (2 min)
		2514	Apt.		
Address	4-6-1, Kachidoki, Chuo-Ku, Tokyo				

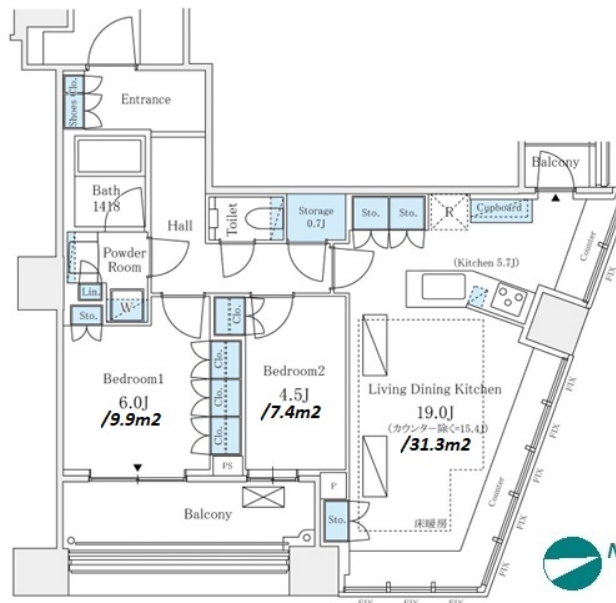

Lease Conditions			
LAYOUT	2 BR		
SIZE	72.46 m ² /779.95 ft ²		
RENT	JPY 383,000 / month		
Management Fee	-		
Deposit	2 months	Key Money	1 month
Lease Term	Standard lease for 24 months		
Available	Now		
Renewal Fee	1 month		
Agent Fee	1 month + tax		
Other Info	Key Replacement Fee : JPY20,000 Tax not included / Guarantor Company : TBC / Auto lock / Air-Con / Separated Toilet / Balcony / Penalty Fee for Early Cancellation / Musical Instrument Negotiable / Flooring / Floor Heating / Dishwasher / Bathroom dryer		

Building Information			
Completion	Aug, 2023	Earthquake Resistance	New
Structure	RC, 58 floors above and 3 basement floors		
Car Parking	N/A		
Bicycle Parking	extra charge		
Music Instrument	Negotiable	Pet	N/A
Facilities	Within 20 min to Tokyo station by car / Front desk / Concierge / Janitor / Delivery box / Elevator / Sky lounge / Security / Close to Station / 24h Garbage Drop-off / Fitness / Gym / High-rise / Newly-built (~7 y/o)		

Remarks
Renters Insurance : Required

*The actual Layout & Size may differ slightly from this floor plans & pictures.



HOUSEREP TOKYO INC.

ハウズレップトーキョー株式会社

#301, 1-4-15, Hiroo, Shibuya-ku, Tokyo 150-0012, Japan

+81 (0)3 6427 5860

inquiry@housserrep-tokyo.com

Transaction Type : Intermediate

Agent Fee : 1 month + tax

Website : www.housserrep-tokyo.com

