

Property Name	NAKAMEGURO WEST	Unit No.	TYPE	Access	Nakameguro Station on Toyoko Line (4 min) Nakameguro Station on Hibiya Line (4 min)
		501	Apt.		
Address	1-6-11, Higashiyama, Meguro-Ku, Tokyo				

Stylish Apartment in Nakameguro, near "Meguro River"

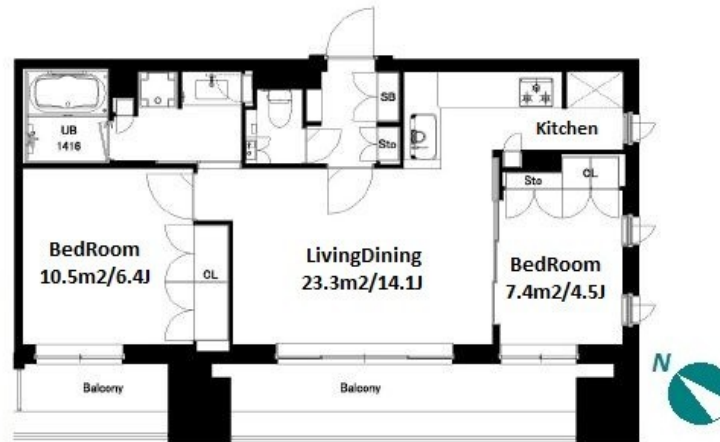

Lease Conditions			
LAYOUT	2 BR		
SIZE	56.09 m²/603.74 ft²		
RENT	JPY 348,000 / month		
Management Fee	JPY12,000/month		
Deposit	2 months	Key Money	1 month
Lease Term	Standard lease for 24 months		
Available	End, Sep, 2024		
Renewal Fee	1 month		
Agent Fee	1 month + tax		
Other Info	Key Replacement Fee : JPY20,000 Tax not included / Guarantor Company : TBC / Auto lock / Air-Con / Separated Toilet / Balcony / Penalty Fee for Early Cancellation / Bathroom dryer		

Building Information			
Completion	Mar, 2015	Earthquake Resistance	New
Structure	RC, 12 floors above		
Car Parking	JPY45,000 + tax / month		
Bicycle Parking	extra charge		
Music Instrument	-	Pet	N/A
Facilities	Within 20 min to Roppongi by train / Near Large Parks / Delivery box / Elevator		

Remarks	
Renters Insurance : Required / Tenant support fee: JPY.15,000+tax/2yrs. / Parking : 1 month deposit	

*The actual Layout & Size may differ slightly from this floor plans & pictures.



HOUSEREP TOKYO INC.

ハウスレップトーキョー株式会社

#301, 1-4-15, Hiroo, Shibuya-ku, Tokyo 150-0012, Japan

+81 (0)3 6427 5860 inquiry@housserep-tokyo.com

Transaction Type : Intermediate

Agent Fee : 1 month + tax

Website : www.housserep-tokyo.com

