

Property Name	PARK AXIS RYOGOKU SQUARE	Unit No.	TYPE	Access	Ryogoku Station on Oedo Line (2 min)
		901	Apt.		
Address	1-16-4, Midori, Sumida-Ku, Tokyo				

Mid-rise Apt. in Ryogoku, Sumida

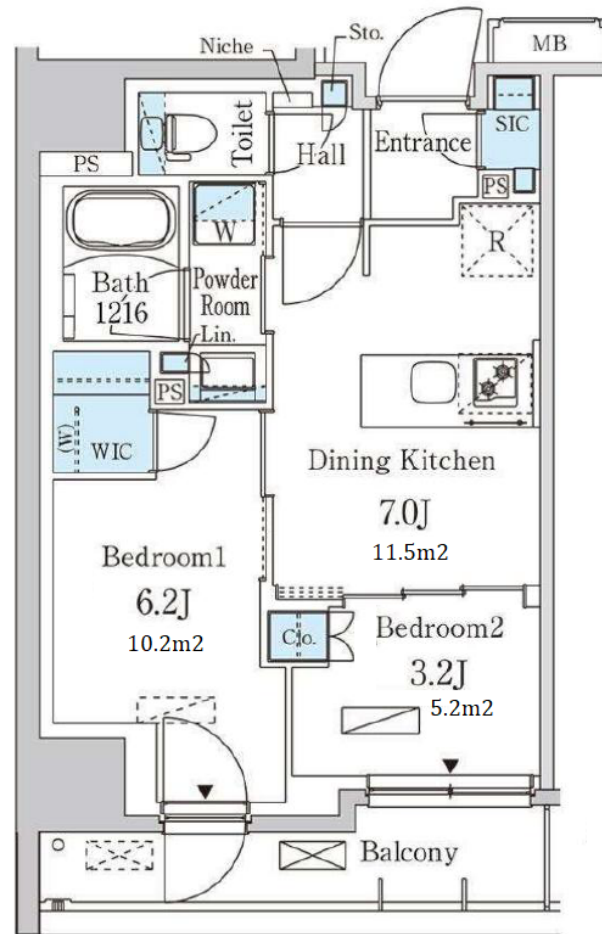

*The actual Layout & Size may differ slightly from this floor plans & pictures.

Lease Conditions	
LAYOUT	2 BR
SIZE	40.59 m ² /436.9 ft ²
RENT	JPY 190,000 / month
Management Fee	JPY15,000/month
Deposit	2 months
Key Money	-
Lease Term	Standard lease for 24 months
Available	Now
Renewal Fee	1 month
Agent Fee	1 month + tax
Other Info	Key Replacement Fee : JPY20,000 Tax not included / Guarantor Company : TBC / No Key Money / Auto lock / Air-Con / Separated Toilet / Balcony / Internet Included / Penalty Fee for Early Cancellation / Musical Instrument Negotiable / Flooring / Bathroom dryer / WIC

Building Information			
Completion	Dec, 2022	Earthquake Resistance	New
Structure	RC, 13 floors above		
Car Parking	N/A		
Bicycle Parking	for 1 space (Included)		
Music Instrument	Negotiable	Pet	Allowed
Facilities	Motorcycle Parking (TBC) / Delivery box / Elevator / Close to Station / Newly-built (~1 y/o)		

Remarks
Renters Insurance : Required / Bicycle parking : Registration fee: 2,000yen+tax. / Pet:additional deposit (1 month) / Pet : a small dog or a cat



HOUSEREP TOKYO INC.

ハウスレップトーキョー株式会社

#301, 1-4-15, Hiroo, Shibuya-ku, Tokyo 150-0012, Japan

+81 (0)3 6427 5860

inquiry@housserrep-tokyo.com

Transaction Type : Intermediate

Agent Fee : 1 month + tax

Website : www.housserrep-tokyo.com

