

|               |                                      |          |      |        |                                                                                                         |
|---------------|--------------------------------------|----------|------|--------|---------------------------------------------------------------------------------------------------------|
| Property Name | COMFORIA SHINJUKU                    | Unit No. | TYPE | Access | Shinjokusannchoume Station on Marunouchi Line (7 min)<br>Higashishinnjuku Station on Oedo Line (10 min) |
|               |                                      | 706      | Apt. |        |                                                                                                         |
| Address       | 5-8-20, Shinjuku, Shinjuku-Ku, Tokyo |          |      |        |                                                                                                         |

## Modern Residence Located Metropolitan City "Shinjuku"

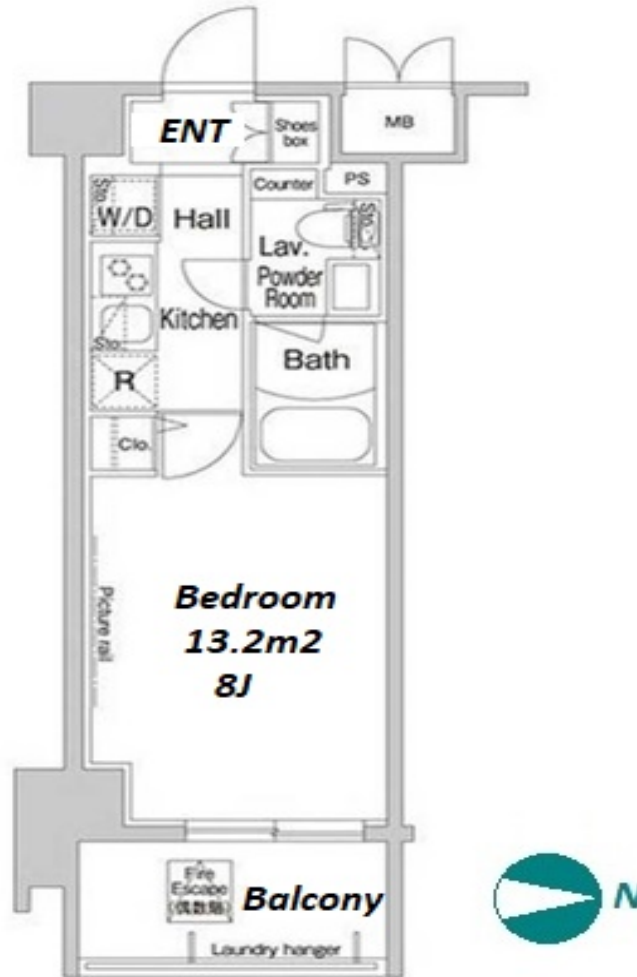
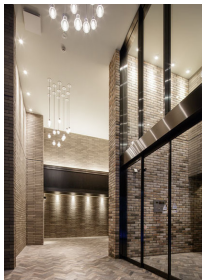

\*The actual Layout & Size may differ slightly from this floor plans & pictures.

| Lease Conditions |                                                                                                                                                                                                       |
|------------------|-------------------------------------------------------------------------------------------------------------------------------------------------------------------------------------------------------|
| LAYOUT           | Studio                                                                                                                                                                                                |
| SIZE             | 25.02 m <sup>2</sup> /269.31 ft <sup>2</sup>                                                                                                                                                          |
| RENT             | JPY 145,000 / month                                                                                                                                                                                   |
| Management Fee   | JPY6,000/month                                                                                                                                                                                        |
| Deposit          | 1 month                                                                                                                                                                                               |
| Key Money        | -                                                                                                                                                                                                     |
| Lease Term       | Standard lease for 24 months                                                                                                                                                                          |
| Available        | End, Oct, 2024                                                                                                                                                                                        |
| Renewal Fee      | 1 month                                                                                                                                                                                               |
| Agent Fee        | 1 month + tax                                                                                                                                                                                         |
| Other Info       | Key Replacement Fee : JPY30,000 Tax not included / Guarantor Company : TBC / Auto lock / Air-Con / Balcony / Internet (Extra Charge) / Penalty Fee for Early Cancellation / Flooring / Bathroom dryer |

| Building Information  |                                                                                                                            |
|-----------------------|----------------------------------------------------------------------------------------------------------------------------|
| Completion            | Mar, 2018                                                                                                                  |
| Earthquake Resistance | New                                                                                                                        |
| Structure             | RC, 11 floors above                                                                                                        |
| Car Parking           | TBC                                                                                                                        |
| Bicycle Parking       | extra charge                                                                                                               |
| Music Instrument      | -                                                                                                                          |
| Pet                   | Allowed                                                                                                                    |
| Facilities            | Motorcycle Parking (extra charge) / Near Large Parks / Janitor / Delivery box / Elevator / Security / 24h Garbage Drop-off |

| Remarks                                                           |
|-------------------------------------------------------------------|
| Renters Insurance : Required / Pet:additional deposit ( 1 month ) |



# HOUSEREP TOKYO INC.

ハウスレップトーキョー株式会社

#301, 1-4-15, Hiroo, Shibuya-ku, Tokyo 150-0012, Japan

+81 (0)3 6427 5860

inquiry@housserrep-tokyo.com

Transaction Type : Intermediate

Agent Fee : 1 month + tax

Website : www.housserrep-tokyo.com

