

Property Name	LA TOUR CHIYODA	Unit No.	TYPE	Access	Kudanshita Station on Tozai Line (5 min) Jinnbouchou Station on Hanzomon Line (6 min) Suidobashi Station on JR Chuo Line Rapid Service (6 min) Iidabashi Station on Yurakucho Line (11 min)
		2405	Apt.		
Address	3-5-3, Nishikanda, Chiyoda-Ku, Tokyo				

## High Rise Tower Residence in Iidabashi /Suidobashi Area

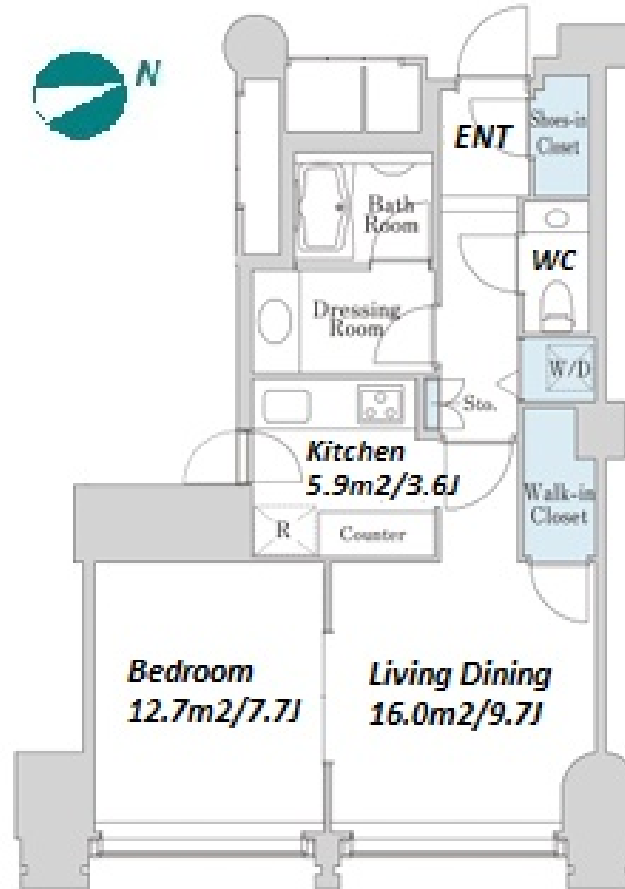

\*The actual Layout & Size may differ slightly from this floor plans & pictures.

Lease Conditions	
LAYOUT	1 BR
SIZE	53.49 m <sup>2</sup> /575.76 ft <sup>2</sup>
RENT	JPY 365,000 / month
Management Fee	-
Deposit	2 months
Key Money	-
Lease Term	Fixed term lease for 36 months
Available	Early, Oct, 2024
Renewal Fee	-
Agent Fee	1 month + tax
Other Info	Depreciation : 1 month / No Key Money / Auto lock / Air-Con / Separated Toilet / Penalty Fee for Early Cancellation / Musical Instrument Negotiable / Oven / WIC

Building Information			
Completion	Jan, 2004	Earthquake Resistance	New
Structure	RC, 32 floors above and 2 basement floors		
Car Parking	TBC		
Bicycle Parking	TBC		
Music Instrument	Negotiable	Pet	Negotiable
Facilities	Motorcycle Parking (TBC) / Trunk Room (TBC) / Gym (( Included )) / Within 20 min to Tokyo station by car / Near Large Parks / French Community / Front desk / Elevator / Close to Station / High-rise		

Remarks



HOUSEREP TOKYO INC.

ハウスレップトーキョー株式会社

#301, 1-4-15, Hiroo, Shibuya-ku, Tokyo 150-0012, Japan

+81 (0)3 6427 5860

inquiry@housserrep-tokyo.com

Transaction Type : Intermediate

Agent Fee : 1 month + tax

Website : www.housserrep-tokyo.com

