

Property Name	URBANEX NIHONBASHI YOKOYAMACHO	Unit No.	TYPE	Access	Bakurochou Station on JR Sobu Line (2 min) Bakurochou Station on Toei Asakusa Line (2 min) Asakusabashi Station on JR Chuo-Sobu Line (6 min)
		902	Apt.		
Address	7-13, Nihombashiyokoyamacho, Chuo-Ku, Tokyo				

Stylish Mid Rise Apt. in Nihonbashi, near "Bakurocho" stn.

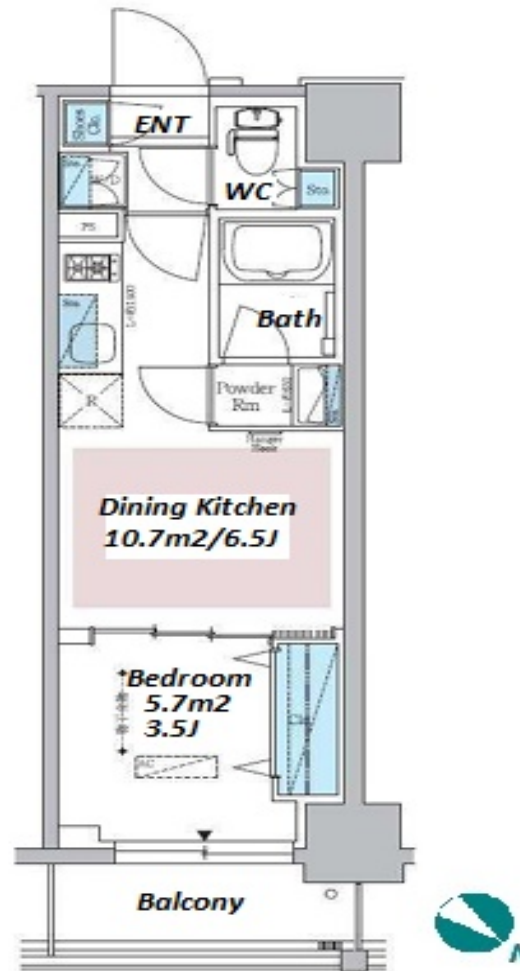

\*The actual Layout & Size may differ slightly from this floor plans & pictures.

Lease Conditions	
LAYOUT	1 BR
SIZE	25.08 m²/269.95 ft²
RENT	JPY 148,000 / month
Management Fee	JPY15,000/month
Deposit	2 months
Key Money	-
Lease Term	Standard lease for 24 months
Available	Now
Renewal Fee	1 month
Agent Fee	1 month + tax
Other Info	Key Replacement Fee : JPY20,000 Tax not included / Guarantor Company : TBC / No Key Money / Auto lock / Air-Con / Separated Toilet / Balcony / Internet Included / Penalty Fee for Early Cancellation / Flooring / Floor Heating / Bathroom dryer

Building Information		
Completion	Feb, 2024	Earthquake Resistance New
Structure	RC, 12 floors above	
Car Parking	TBC	
Bicycle Parking	for 1 space JPY500 + tax / month	
Music Instrument	-	Pet N/A
Facilities	Within 20 min to Tokyo station by car / Janitor / Delivery box / Elevator / Close to Station / 24h Garbage Drop-off / Newly-built (~1 y/o)	



HOUSEREP TOKYO INC.

ハウスレップトーキョー株式会社

#301, 1-4-15, Hiroo, Shibuya-ku, Tokyo 150-0012, Japan

+81 (0)3 6427 5860 inquiry@housserep-tokyo.com

Transaction Type : Intermediate

Agent Fee : 1 month + tax

Website : www.housserep-tokyo.com



Remarks
Renters Insurance : Required