

Property Name	OAK COURT	Unit No.	TYPE	Access	Nishishinjuku Station on Marunouchi Line (3 min) Tochoumae Station on Oedo Line (6 min) Shinnjuku Station on JR Yamanote Line (10 min)
		1006	Apt.		
Address	6-9-1, Nishishinjuku, Shinjuku-Ku, Tokyo				

## Mid-rise Residence in Nishi-Shinjuku, near Central Park

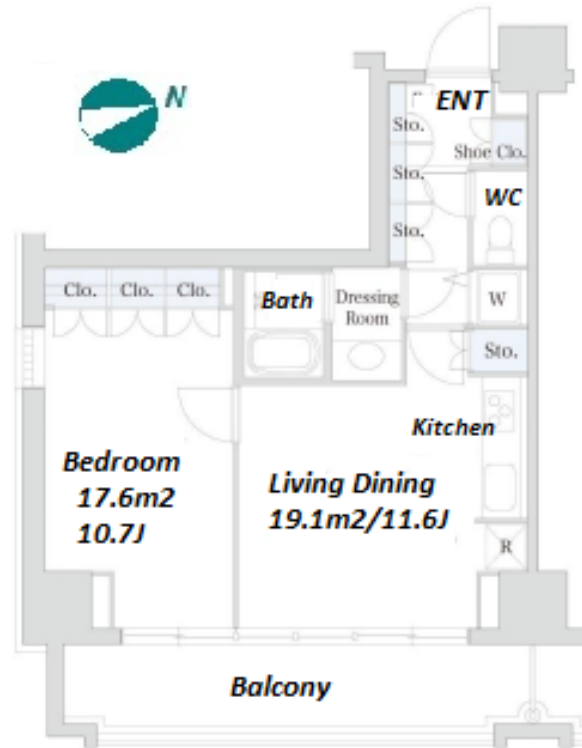

Lease Conditions	
LAYOUT	1 BR
SIZE	49.7 m <sup>2</sup> /534.96 ft <sup>2</sup>
RENT	JPY 271,000 / month
Management Fee	-
Deposit	2 months
Key Money	-
Lease Term	Fixed term lease for 36 months
Available	Mid, Sep, 2024
Renewal Fee	-
Agent Fee	1 month + tax
Other Info	Depreciation : 1 month / Guarantor Company : TBC / No Key Money / Auto lock / Air-Con / Separated Toilet / Balcony / Penalty Fee for Early Cancellation / Musical Instrument Negotiable / Floor Heating / Bathroom dryer

Building Information			
Completion	Nov, 2002	Earthquake Resistance	New
Structure	RC, 12 floors above and 1 basement floors		
Car Parking	JPY45,000 ~ 80,000 + tax / month		
Bicycle Parking	TBC		
Music Instrument	Negotiable	Pet	N/A
Facilities	Motorcycle Parking (JPY7,000 + tax / month) / Near Large Parks / Janitor / Delivery box / Elevator / Close to Station		

Remarks
Renters Insurance : Required / Parking : 3.3 months deposit / Bicycle parking : Registration fee: JPY.1,000+tax

\*The actual Layout & Size may differ slightly from this floor plans & pictures.



# HOUSEREP TOKYO INC.

ハウスレップトーキョー株式会社

#301, 1-4-15, Hiroo, Shibuya-ku, Tokyo 150-0012, Japan

+81 (0)3 6427 5860

inquiry@housserrep-tokyo.com

Transaction Type : Intermediate

Agent Fee : 1 month + tax

Website : www.housserrep-tokyo.com

