

Property Name	KDX RESIDENCE KAGURAZAKADORI	Unit No.	TYPE	Access	Kagurazaka Station on Tozai Line (1 min) Ushigomekagurazaka Station on Oedo Line (8 min) Iidabashi Station on JR Chuo-Sobu Line (15 min)
		1105	Apt.		
Address	120-1, Yaraicho, Shinjuku-Ku, Tokyo				

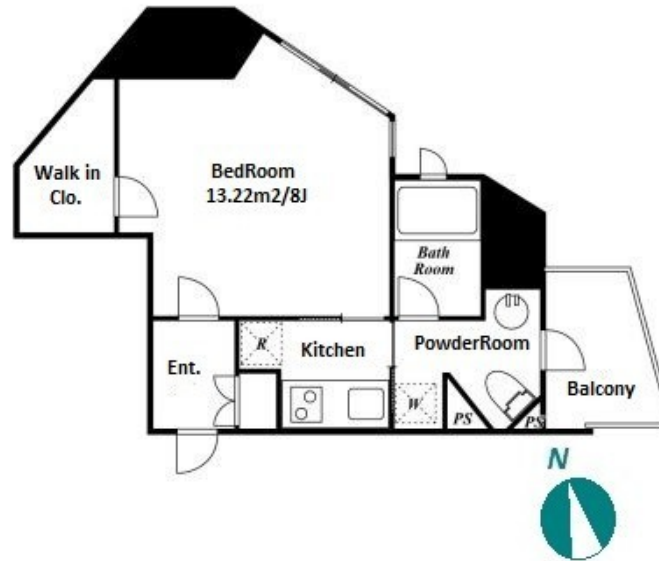

Lease Conditions

LAYOUT	Studio		
SIZE	27.32 m ² /294.07 ft ²		
RENT	JPY 123,000 / month		
Management Fee	JPY10,000/month		
Deposit	2 months	Key Money	1 month
Lease Term	Standard lease for 24 months		
Available	Now		
Renewal Fee	1 month		
Agent Fee	1 month + tax		
Other Info	Key Replacement Fee : JPY18,000 Tax not included / Guarantor Company : TBC / Auto lock / Air-Con / Separated Toilet / Balcony / Penalty Fee for Early Cancellation / Flooring / Bathroom dryer / WIC / Corner Unit		

Building Information

Completion	Aug, 2006	Earthquake Resistance	New
Structure	RC, 15 floors above and 1 basement floors		
Car Parking	N/A		
Bicycle Parking	N/A		
Music Instrument	-	Pet	N/A
Facilities	Janitor / Delivery box / Elevator / Security / Close to Station / High-rise		

Remarks

Remarks

*The actual Layout & Size may differ slightly from this floor plans & pictures.



HOUSEREP TOKYO INC.

ハウスレップトーキョー株式会社

#301, 1-4-15, Hiroo, Shibuya-ku, Tokyo 150-0012, Japan

+81 (0)3 6427 5860

inquiry@housserep-tokyo.com

Transaction Type : Intermediate

Agent Fee : 1 month + tax

Website : www.housserep-tokyo.com

