

Property Name	NAKANO STATION RESIDENCE	Unit No.	TYPE	Access	Nakano Station on JR Chuo Line Rapid Service (2 min) Nakano Station on Tozai Line (2 min)
		1808	Apt.		
Address	2-24-9, Nakano, Nakano-Ku, Tokyo				

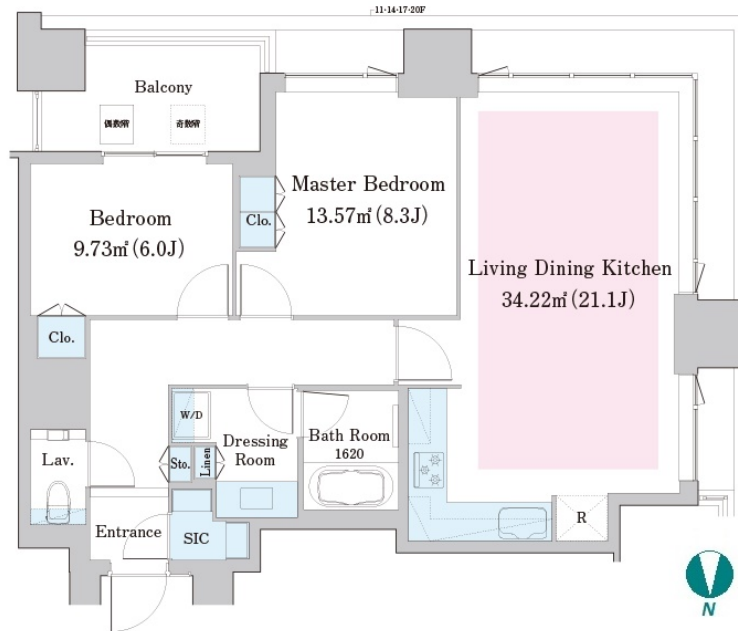
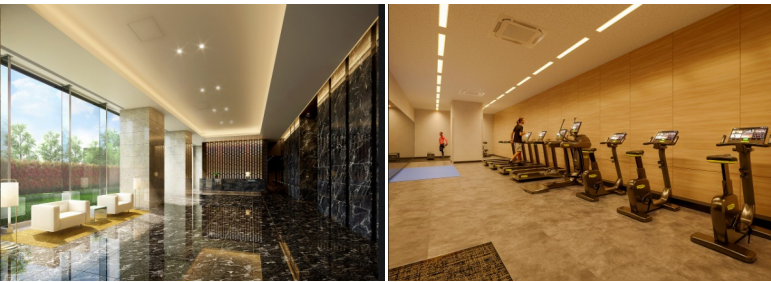

Lease Conditions

LAYOUT	2 BR		
SIZE	83.38 m²/897.49 ft²		
RENT	JPY 529,000 / month		
Management Fee	-		
Deposit	2 months	Key Money	-
Lease Term	Fixed term lease for 36 months		
Available	Now		
Renewal Fee	-		
Agent Fee	1 month + tax		
Other Info	Depreciation : 1 month / Guarantor Company : TBC / No Key Money / Internet (Extra Charge) / Penalty Fee for Early Cancellation / Floor Heating / Bathroom dryer		

Building Information

Completion	Feb, 2024	Earthquake Resistance	New
Structure	RC, 37 floors above and 2 basement floors		
Car Parking	JPY40,000 + tax / month		
Bicycle Parking	extra charge		
Music Instrument	-	Pet	Allowed
Facilities	Motorcycle Parking (extra charge) / Concierge / Janitor / Delivery box / Elevator / Security / Close to Station / Fitness / Gym / High-rise / Newly-built (~1 y/o)		

Remarks

Renters Insurance : Required / Pet:additional deposit (1 month)

*The actual Layout & Size may differ slightly from this floor plans & pictures.



HOUSEREP TOKYO INC.

ハウスレップトーキョー株式会社

#301, 1-4-15, Hiroo, Shibuya-ku, Tokyo 150-0012, Japan

+81 (0)3 6427 5860

inquiry@housserrep-tokyo.com

Transaction Type : Intermediate

Agent Fee : 1 month + tax

Website : www.housserrep-tokyo.com

