

Property Name	RESIDIA BUNKYO YUSHIMA	Unit No.	TYPE	Access	Honngousannchoume Station on Marunouchi Line (8 min)
		501	Apt.		
Address	2-18-2, Yushima, Bunkyo-Ku, Tokyo				

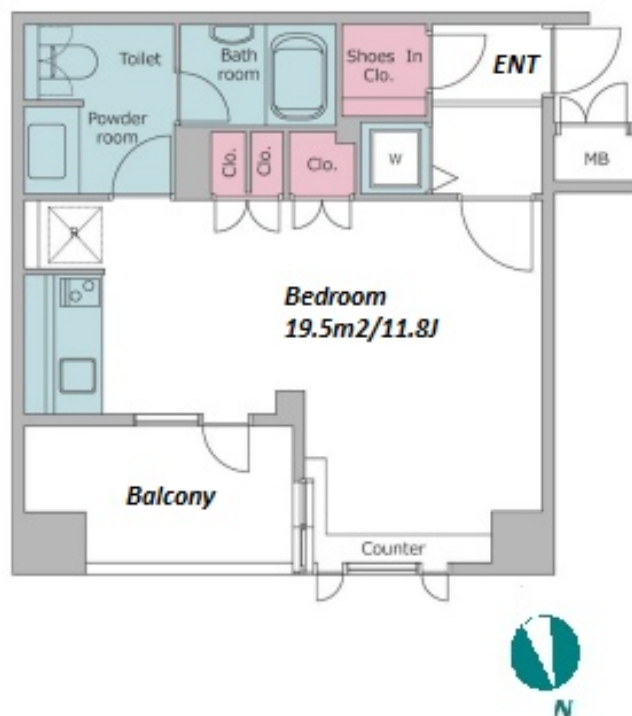

Lease Conditions		
LAYOUT	Studio	
SIZE	31.4 m²/337.98 ft²	
RENT	JPY 145,000 / month	
Management Fee	JPY10,000/month	
Deposit	2 months	Key Money -
Lease Term	Standard lease for 24 months	
Available	End, Jul, 2024	
Renewal Fee	1 month	
Agent Fee	1 month + tax	
Other Info	Key Replacement Fee : JPY18,000 Tax not included / Guarantor Company : TBC / No Key Money / Auto lock / Renovated / Air-Con / Separated Toilet / Balcony / Internet (Extra Charge) / Penalty Fee for Early Cancellation / Flooring	

Building Information			
Completion	Feb, 2003	Earthquake Resistance	New
Structure	RC, 11 floors above		
Car Parking	N/A		
Bicycle Parking	TBC		
Music Instrument	-	Pet	N/A
Facilities	Within 20 min to Tokyo station by car / Near Large Parks / Delivery box / Elevator		

Remarks	
Renters Insurance : Required / Tenant support fee: JPY.10,000+tax/2years Internet fee: JPY.1,500+tax/month	

*The actual Layout & Size may differ slightly from this floor plans & pictures.



HOUSEREP TOKYO INC.

ハウズレップトーキョー株式会社

#301, 1-4-15, Hiroo, Shibuya-ku, Tokyo 150-0012, Japan

+81 (0)3 6427 5860

inquiry@housserep-tokyo.com

Transaction Type : Intermediate

Agent Fee : 1 month + tax

Website : www.housserep-tokyo.com

