

Property Name	ROYAL PARKS TOYOSU	Unit No.	TYPE	Access	Toyosu Station on Yurakucho Line (5 min) Toyosu Station on (7 min)
		0432	Apt.		
Address	3-5-21, Toyosu, Koto-Ku, Tokyo				

Luxury Residence in Toyosu / Tokyo Bay Area

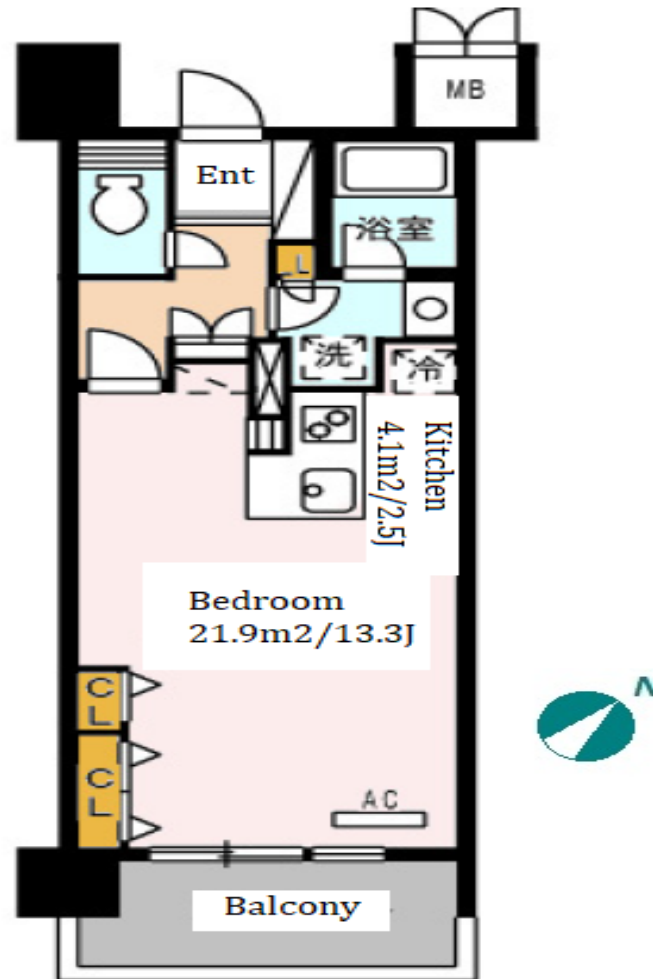

*The actual Layout & Size may differ slightly from this floor plans & pictures.

Lease Conditions			
LAYOUT	Studio		
SIZE	40.56 m²/436.58 ft²		
RENT	JPY 146,000 / month		
Management Fee	JPY12,000/month		
Deposit	2 months	Key Money	1 month
Lease Term	Fixed term lease for 60 months		
Available	27, Jul, 2024		
Renewal Fee	1.1 months		
Agent Fee	1 month + tax		
Other Info	Key Replacement Fee : JPY13,200 Tax included / Guarantor Company : TBC / No Key Money / Auto lock / Air-Con / Separated Toilet / Balcony / Penalty Fee for Early Cancellation / BBQ place / Flooring / Floor Heating / Bathroom dryer		

Building Information			
Completion	Feb, 2007	Earthquake Resistance	New
Structure	RC, 14 floors above and 1 basement floors		
Car Parking	JPY21,000 + tax / month		
Bicycle Parking	(Included)		
Music Instrument	-	Pet	Negotiable
Facilities	Motorcycle Parking (JPY2,000/ month) / Trunk Room (JPY7,000 ~ 14,000/ month) / Within 20 min to Tokyo station by car / Near Large Parks / Designer's / Front desk / Concierge / Delivery box / Elevator		

Remarks
Fixed term lease : Re-contract fee: 1.1 month of new rent + Tax / Renters Insurance : Required / Pet: additional fee 4,000yen/month / Parking : Additional brokerage fee needed



HOUSEREP TOKYO INC.

ハウスレップトーキョー株式会社

#301, 1-4-15, Hiroo, Shibuya-ku, Tokyo 150-0012, Japan

+81 (0)3 6427 5860

inquiry@housserrep-tokyo.com

Transaction Type : Intermediate

Agent Fee : 1 month + tax

Website : www.housserrep-tokyo.com

