

| | | | | | |
|---------------|-----------------------------------|----------|------|--------|--|
| Property Name | SHINONOME CANAL COURT CODAN 21 | Unit No. | TYPE | Access | Tatsumi Station on Yurakucho Line (9 min) Shinonome Station on Rinkai Line (10 min) |
| | | 1206 | Apt. | | |
| Address | 1-9-21, Shinonome, Koto-Ku, Tokyo | | | | |

Massive Complex Located in "Shinonome" Water Front Area

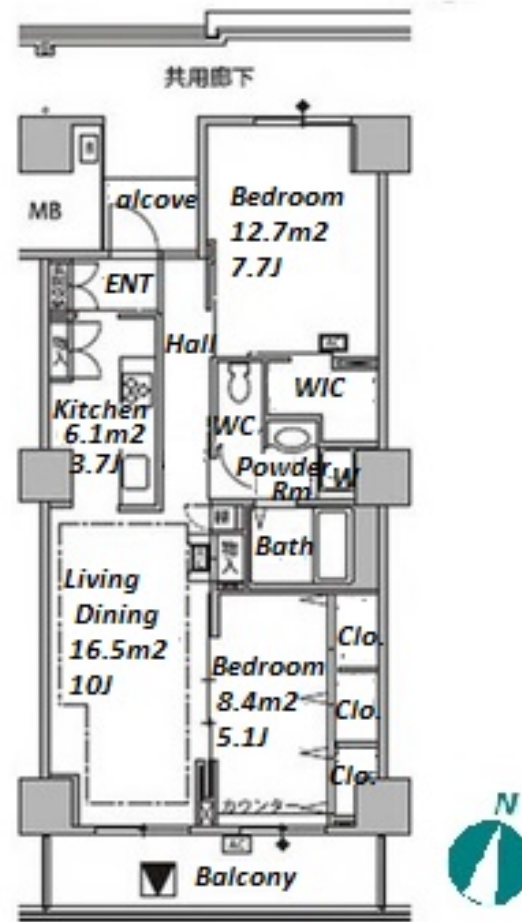

*The actual Layout & Size may differ slightly from this floor plans & pictures.

| Lease Conditions | | |
|------------------|---|-------------------|
| LAYOUT | 2 BR | |
| SIZE | 70.44 m ² /758.2 ft ² | |
| RENT | JPY 250,000 / month | |
| Management Fee | JPY 15,000/month | |
| Deposit | 2 months | Key Money 1 month |
| Lease Term | Standard lease for 24 months | |
| Available | End, Aug, 2024 | |
| Renewal Fee | 1 month | |
| Agent Fee | 1 month + tax | |
| Other Info | Key Replacement Fee : JPY30,000 Tax not included / Guarantor Company : TBC / Auto lock / Air-Con / Separated Toilet / Balcony / CS/CATV / Flooring / Floor Heating / Bathroom dryer / WIC | |

| Building Information | | |
|----------------------|---|---------------------------|
| Completion | Mar, 2005 | Earthquake Resistance New |
| Structure | RC, 14 floors above and 1 basement floors | |
| Car Parking | TBC | |
| Bicycle Parking | (Included) | |
| Music Instrument | - | Pet N/A |
| Facilities | Motorcycle Parking (extra charge) / Near Large Parks / Designer's / Janitor / Delivery box / Elevator | |

| Remarks |
|------------------------------|
| Renters Insurance : Required |



HOUSEREP TOKYO INC.

ハウスレップトーキョー株式会社

#301, 1-4-15, Hiroo, Shibuya-ku, Tokyo 150-0012, Japan

+81 (0)3 6427 5860

inquiry@housserrep-tokyo.com

Transaction Type : Intermediate

Agent Fee : 1 month + tax

Website : www.housserrep-tokyo.com

