

Property Name	PARK AXIS OCHANOMIZU STAGE	Unit No.	TYPE	Access	Suehirochou Station on <b>Ginza</b> Line (6 min) Yushima Station on <b>Chiyoda</b> Line (6 min) Ochanomizu Station on <b>JR Chuo</b> Line Rapid Service (8 min) Akihabara Station on <b>JR Yamanote</b> Line (13 min)
		602	Apt.		
Address	3-2-14, Yushima, Bunkyo-Ku, Tokyo				

Lease Conditions			
LAYOUT	Studio		
SIZE	29.7 m <sup>2</sup> /319.68 ft <sup>2</sup>		
RENT	JPY 137,000 / month		
Management Fee	JPY8,000/month		
Deposit	2 months	Key Money	1 month
Lease Term	Standard lease for 24 months		
Available	Mid, Jun, 2024		
Renewal Fee	1 month		
Agent Fee	1 month + tax		
Other Info	Key Replacement Fee : JPY15,000 Tax not included / Guarantor Company : TBC / Auto lock / Air-Con / Separated Toilet / Balcony / Penalty Fee for Early Cancellation / Musical Instrument Negotiable / CS/CATV / Flooring / Floor Heating / Bathroom dryer		
Building Information			
Completion	Feb, 2006	Earthquake Resistance	New
Structure	RC, 14 floors above		
Car Parking	TBC		
Bicycle Parking	for 1 space ( Included )		
Music Instrument	Negotiable	Pet	Allowed
Facilities	Motorcycle Parking (TBC) / Within 20 min to Tokyo station by car / Janitor / Delivery box / Elevator / Security		
Remarks			

# Mid-rise Apt. in Ochanomizu, near Akihabara

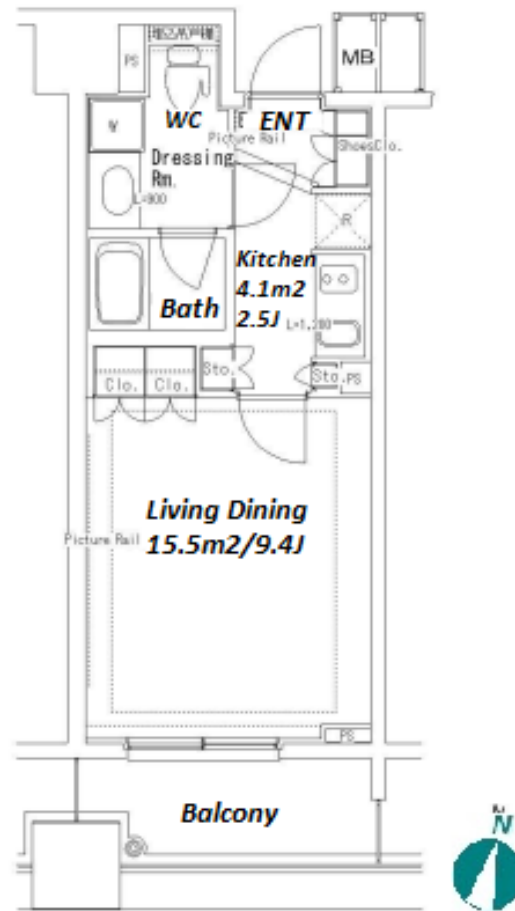

Renters Insurance : Required / Bicycle parking : Registration fee:  
JPY.2,000+tax / Pet:additional deposit ( 1 month ) / Pet : up to two small  
dogs/ No cat

\*The actual Layout & Size may differ slightly from this floor plans & pictures.



**HOUSEREP TOKYO INC.**

ハウスレップトーキョー株式会社

#301, 1-4-15, Hiroo, Shibuya-ku, Tokyo 150-0012, Japan

+81 (0)3 6427 5860 inquiry@houserep-tokyo.com

Transaction Type : Intermediate

Agent Fee : 1 month + tax

Website : [www.houserep-tokyo.com](http://www.houserep-tokyo.com)

