

Property Name	COMFORIA GINZA EAST	Unit No.	TYPE	Access	Hacchoubori Station on Hibiya Line (2 min) Shinntomichou Station on Yurakucho Line (5 min)
		911	Apt.		
Address	1-3-1, Irifune, Chuo-Ku, Tokyo				

Modern Mid Rize Apt. in Ginza, Near Hacchobori stn.

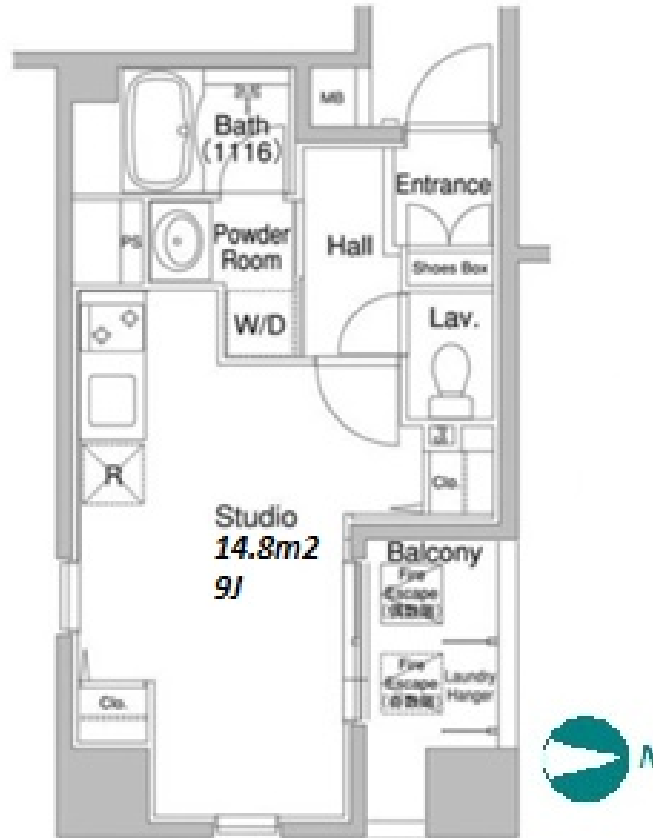

\*The actual Layout & Size may differ slightly from this floor plans & pictures.

Lease Conditions	
LAYOUT	Studio
SIZE	28.06 m <sup>2</sup> /302.03 ft <sup>2</sup>
RENT	JPY 111,000 / month
Management Fee	JPY10,000/month
Deposit	2 months <b>Key Money</b> -
Lease Term	Standard lease for 24 months
Available	End, Aug, 2024
Renewal Fee	1 month
Agent Fee	1 month + tax
Other Info	Key Replacement Fee : JPY20,000 Tax not included / Guarantor Company : TBC / No Key Money / Auto lock / Air-Con / Separated Toilet / Balcony / Internet (Extra Charge) / Penalty Fee for Early Cancellation / CS/CATV / Flooring / Bathroom dryer

Building Information			
Completion	Mar, 2005	Earthquake Resistance	New
Structure	SRC, 14 floors above		
Car Parking	N/A		
Bicycle Parking	extra charge		
Music Instrument	-	Pet	Allowed
Facilities	Within 20 min to Tokyo station by car / Near Large Parks / Janitor / Delivery box / Elevator / Security		

Remarks
Renters Insurance : Required / Pet:additional deposit ( 1 month ) / Pet : a small dog or up to two cats



HOUSEREP TOKYO INC.

ハウスレップトーキョー株式会社

#301, 1-4-15, Hiroo, Shibuya-ku, Tokyo 150-0012, Japan

+81 (0)3 6427 5860

inquiry@housserrep-tokyo.com

Transaction Type : Intermediate

Agent Fee : 1 month + tax

Website : www.housserrep-tokyo.com

