

Property Name	PARK AXIS TOYOCHO SHINSUI KOEN	Unit No.	TYPE	Access	Minamisunamachi Station on Tozai Line (11 min)
		1204	Apt.		
Address	2-34-4, Minamisuna, Koto-Ku, Tokyo				

Mid-rise Apt. in Toyochō, Koto

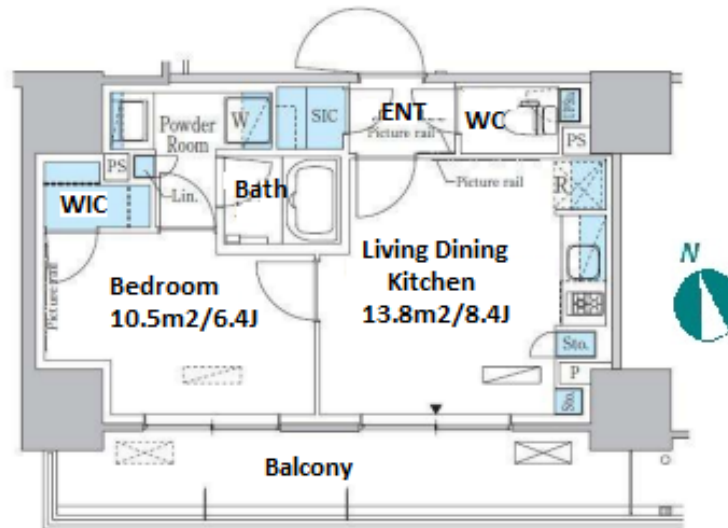

Lease Conditions		
LAYOUT	1 BR	
SIZE	38.75 m²/417.1 ft²	
RENT	JPY 146,000 / month	
Management Fee	JPY12,000/month	
Deposit	2 months	Key Money 1 month
Lease Term	Standard lease for 24 months	
Available	Mid, Jul, 2024	
Renewal Fee	1 month	
Agent Fee	1 month + tax	
Other Info	Key Replacement Fee : JPY15,000 Tax not included / Guarantor Company : TBC / Auto lock / Air-Con / Separated Toilet / Balcony / Penalty Fee for Early Cancellation / Musical Instrument Negotiable / CS/CATV / Flooring / Bathroom dryer / WIC	

Building Information		
Completion	Aug, 2014	Earthquake Resistance New
Structure	RC, 14 floors above	
Car Parking	-	
Bicycle Parking	for 1 space (Included)	
Musical Instrument	Negotiable	Pet Allowed
Facilities	Motorcycle Parking (TBC) / Trunk Room (JPY5,000/ month) / Near Large Parks / Delivery box / Elevator	

*The actual Layout & Size may differ slightly from this floor plans & pictures.



HOUSEREP TOKYO INC.

ハウスレップトーキョー株式会社

#301, 1-4-15, Hiroo, Shibuya-ku, Tokyo 150-0012, Japan

+81 (0)3 6427 5860 inquiry@housserep-tokyo.com

Transaction Type : Intermediate

Agent Fee : 1 month + tax

Website : www.housserep-tokyo.com



Remarks
Renters Insurance : Required / Bicycle parking : Registration fee: JPY.2,000+tax / Pet:additional deposit (1 month) / Pet : a small dog or a cat