

Property Name	LIVIO MAISON YOKOHAMA ODORI KOEN	Unit No.	TYPE	Access	Bannoubashi Station on Blue Line (4 min) Isezakichoujamachi Station on Blue Line (6 min)
		506	Apt.		
Address	3, Yayoicho, Naka-Ku, Yokohama-Shi, Kanagawa				

New Mid Rise Apt. in Yokohama near Odori Park

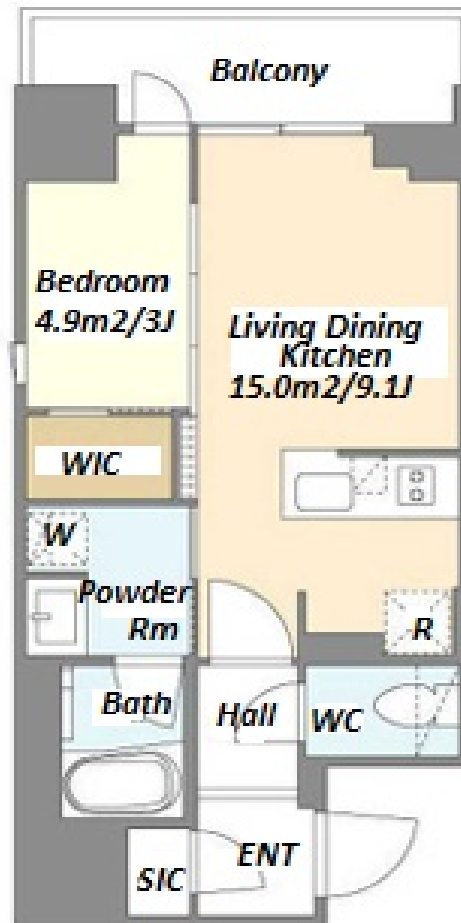

Lease Conditions		
LAYOUT	1 BR	
SIZE	32.38 m ² /348.53 ft ²	
RENT	JPY 122,000 / month	
Management Fee	JPY10,000/month	
Deposit	2 months	Key Money -
Lease Term	Standard lease for 24 months	
Available	End, May, 2024	
Renewal Fee	1 month	
Agent Fee	1 month + tax	
Other Info	Key Replacement Fee : JPY20,000 Tax not included / Guarantor Company : TBC / No Key Money / Auto lock / Air-Con / Separated Toilet / Balcony / Internet Included / Penalty Fee for Early Cancellation / CS/CATV / Flooring / Bathroom dryer / WIC / Corner Unit	

Building Information		
Completion	Sep, 2022	Earthquake Resistance New
Structure	RC, 11 floors above	
Car Parking	TBC	
Bicycle Parking	JPY300 + tax / month	
Music Instrument	-	Pet Allowed
Facilities	Motorcycle Parking (extra charge) / Near Large Parks / Delivery box / Elevator / Newly-built (~7 y/o)	

*The actual Layout & Size may differ slightly from this floor plans & pictures.



HOUSEREP TOKYO INC.

ハウスレップトーキョー株式会社

#301, 1-4-15, Hiroo, Shibuya-ku, Tokyo 150-0012, Japan

+81 (0)3 6427 5860

inquiry@housserep-tokyo.com

Transaction Type : Intermediate

Agent Fee : 1 month + tax

Website : www.housserep-tokyo.com



Remarks
Pet:additional deposit (1 month) / Pet : a small dog or a cat