

Property Name	MARSH FIELD YONBANCHO	Unit No.	TYPE	Access	Ichigaya Station on JR Chuo Line Rapid Service (3 min) Hannzoumonn Station on Hanzomon Line (12 min)
		403	Apt.		
Address	6-11, Yombancho, Chiyoda-Ku, Tokyo				

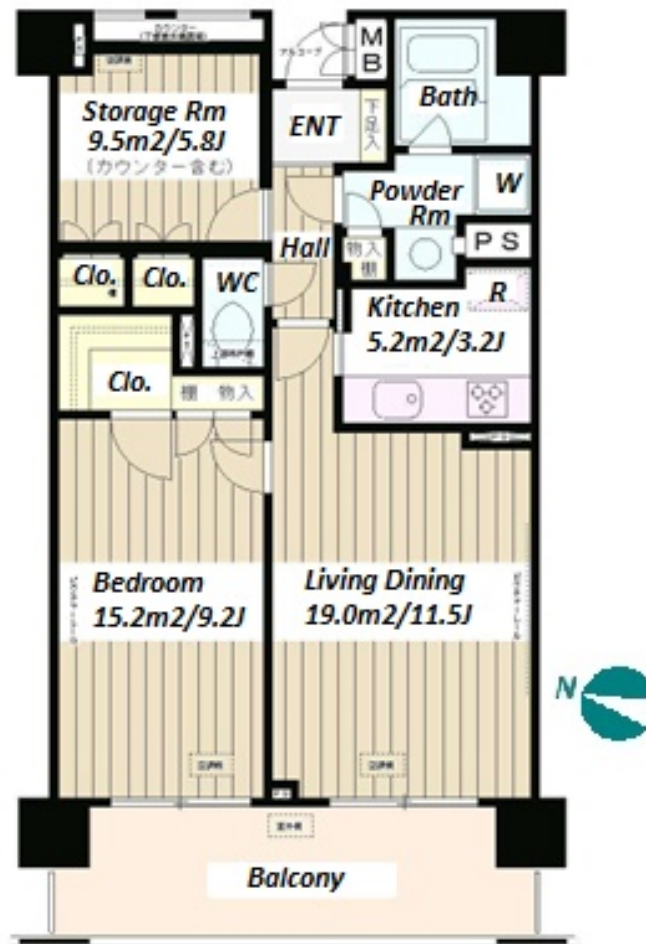

*The actual Layout & Size may differ slightly from this floor plans & pictures.

Lease Conditions	
LAYOUT	1 BR+S
SIZE	66.24 m²/713 ft²
RENT	JPY 305,000 / month
Management Fee	JPY15,000/month
Deposit	2 months
Key Money	2 months
Lease Term	Standard lease for 24 months
Available	Negotiable
Renewal Fee	1 month
Agent Fee	1 month + tax
Other Info	Key Replacement Fee : JPY20,000 Tax not included / Guarantor Company : TBC / Auto lock / Air-Con / Separated Toilet / Balcony / Penalty Fee for Early Cancellation / Musical Instrument Negotiable / Flooring

Building Information	
Completion	May, 1998
Earthquake Resistance	New
Structure	SRC, 12 floors above and 1 basement floors
Car Parking	JPY42,000 + tax / month
Bicycle Parking	for 1 space (Included)
Music Instrument	Negotiable
Pet	-
Facilities	Janitor / Delivery box / Close to Station

Remarks
Renters Insurance : Required



HOUSEREP TOKYO INC.

ハウスレップトーキョー株式会社

#301, 1-4-15, Hiroo, Shibuya-ku, Tokyo 150-0012, Japan

+81 (0)3 6427 5860

inquiry@housserrep-tokyo.com

Transaction Type : Intermediate

Agent Fee : 1 month + tax

Website : www.housserrep-tokyo.com

