

Property Name	PARK AXIS SANBANCHO	Unit No.	TYPE	Access	Hannzoumonn Station on Hanzomon Line (6 min) Ichigaya Station on JR Chuo Line Rapid Service (13 min)
		401	Apt.		
Address	3-2, Sambancho, Chiyoda-Ku, Tokyo				

New "Park Axis" series apartment in Hanzomon, Chiyoda.

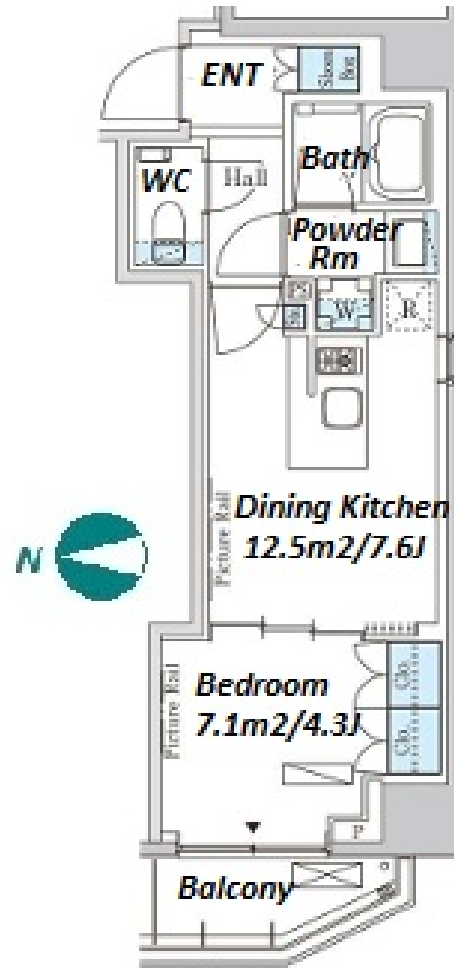

*The actual Layout & Size may differ slightly from this floor plans & pictures.

Lease Conditions	
LAYOUT	1 BR
SIZE	32.83 m ² /353.37 ft ²
RENT	JPY 192,000 / month
Management Fee	JPY15,000/month
Deposit	2 months
Key Money	-
Lease Term	Standard lease for 24 months
Available	Now
Renewal Fee	1 month
Agent Fee	1 month + tax
Other Info	Key Replacement Fee : JPY15,000 Tax not included / Guarantor Company : TBC / No Key Money / Free rent / Auto lock / Air-Con / Separated Toilet / Balcony / Penalty Fee for Early Cancellation / Musical Instrument Negotiable / Flooring / Bathroom dryer

Building Information			
Completion	Feb, 2021	Earthquake Resistance	New
Structure	RC, 9 floors above		
Car Parking	N/A		
Bicycle Parking	JPY1,000 + tax / month		
Music Instrument	Negotiable	Pet	Allowed
Facilities	Motorcycle Parking (TBC) / Near Large Parks / Elevator / Newly-built (~7 y/o)		

Remarks
Renters Insurance : Required / Bicycle parking : registration fee : JPY1,000+tax / Pet:additional deposit (1 month)



HOUSEREP TOKYO INC.

ハウスレップトーキョー株式会社

#301, 1-4-15, Hiroo, Shibuya-ku, Tokyo 150-0012, Japan

+81 (0)3 6427 5860

inquiry@housserrep-tokyo.com

Transaction Type : Intermediate

Agent Fee : 1 month + tax

Website : www.housserrep-tokyo.com

