

Property Name	KOLET MEIDAIMAE	Unit No.	TYPE	Access	Daitabashi Station on Keio Line (8 min) Meidaimae Station on Keio Inokashira Line (11 min)
			House		
Address	2-5-58, Izumi, Suginami-Ku, Tokyo				

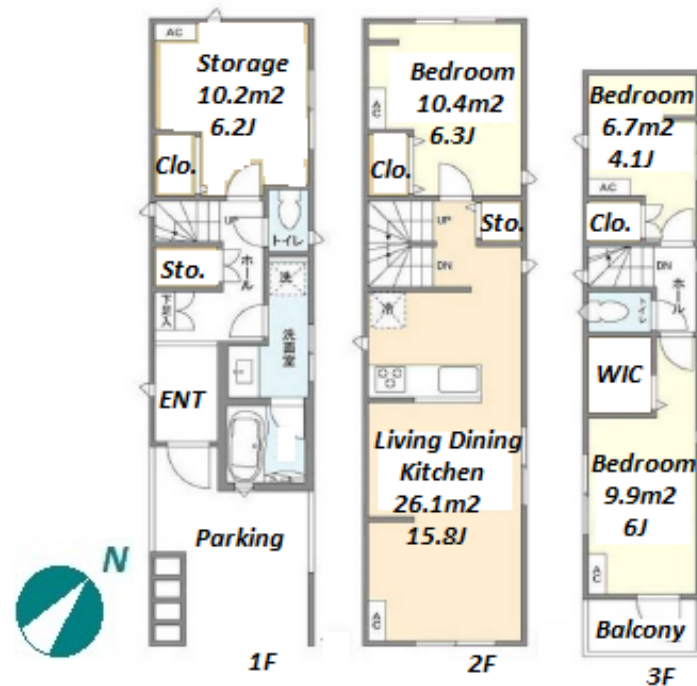

Lease Conditions	
LAYOUT	3 BR+S
SIZE	93.56 m ² /1007.07 ft ²
RENT	JPY 375,000 / month
Management Fee	-
Deposit	2 months
Key Money	-
Lease Term	Standard lease for 24 months
Available	Now
Renewal Fee	1 month
Agent Fee	1 month + tax
Other Info	Guarantor Company : TBC / Air-Con / Separated Toilet / Balcony / Internet (Extra Charge) / Penalty Fee for Early Cancellation / Musical Instrument Negotiable / Flooring / Bathroom dryer / WIC / 2 Toilets

Building Information			
Completion	Jan, 2023	Earthquake Resistance	New
Structure	Wooden, 3 floors above		
Car Parking	for 1 space (Included)		
Bicycle Parking	-		
Music Instrument	Negotiable	Pet	Negotiable
Facilities	House / Delivery box / Newly-built (~1 y/o)		

Remarks
Renters Insurance : Required

*The actual Layout & Size may differ slightly from this floor plans & pictures.



HOUSEREP TOKYO INC.

ハウスレップトーキョー株式会社

#301, 1-4-15, Hiroo, Shibuya-ku, Tokyo 150-0012, Japan

+81 (0)3 6427 5860

inquiry@housserrep-tokyo.com

Transaction Type : Intermediate

Agent Fee : 1 month + tax

Website : www.housserrep-tokyo.com

