

Property Name	LA TOUR SHINJUKU GARDEN	Unit No.	TYPE	Access	Takadanobaba Station on JR Yamanote Line (7 min) Shinnookubo Station on JR Yamanote Line (10 min)
		2603	Apt.		
Address	3-8-3, Okubo, Shinjuku-Ku, Tokyo				

## Luxury Tower Residence in Shinjuku area, near Korea Town

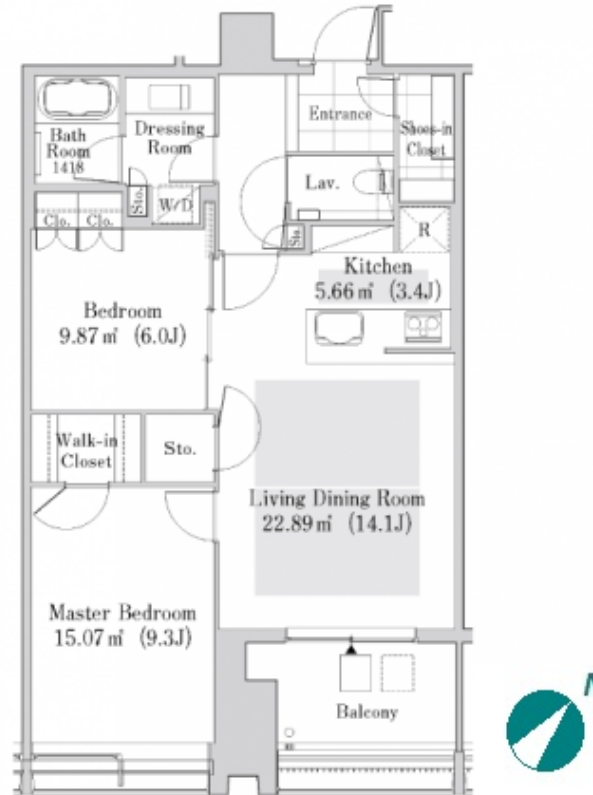

Lease Conditions	
LAYOUT	2 BR
SIZE	76.32 m²/821.5 ft²
RENT	JPY 500,000 / month
Management Fee	-
Deposit	2 months
Key Money	-
Lease Term	Fixed term lease for 36 months
Available	Mid, Sep, 2024
Renewal Fee	-
Agent Fee	1 month + tax
Other Info	Depreciation : 1 month / Guarantor Company : TBC / No Key Money / Auto lock / Air-Con / Separated Toilet / Balcony / Internet Included / Penalty Fee for Early Cancellation / Flooring / Floor Heating / Bathroom dryer / WIC

Building Information			
Completion	Mar, 2016	Earthquake Resistance	New
Structure	SRC, 37 floors above and 2 basement floors		
Car Parking	JPY35,000 ~ 60,000/ month		
Bicycle Parking	extra charge		
Music Instrument	-	Pet	Allowed
Facilities	Motorcycle Parking (extra charge) / Trunk Room (extra charge) / Gym (( Included )) / Near Large Parks / Front desk / Concierge / Elevator / Sky lounge / High-rise		

Remarks
Pet:additional deposit ( 1 month )

\*The actual Layout & Size may differ slightly from this floor plans & pictures.



**HOUSEREP TOKYO INC.**  
ハウスレップトーキョー株式会社

#301, 1-4-15, Hiroo, Shibuya-ku, Tokyo 150-0012, Japan  
+81 (0)3 6427 5860 inquiry@housserrep-tokyo.com

Transaction Type : Intermediate  
Agent Fee : 1 month + tax

Website : www.housserrep-tokyo.com

