

Property Name	PARK AXIS KODENMACHO	Unit No.	TYPE	Access	Kodenmachou Station on Hibiya Line (3 min) Bakurochou Station on JR Sobu Line (5 min) Kannda Station on JR Yamanote Line (10 min)
		805	Apt.		
Address	1-7-8, Iwamotocho, Chiyoda-Ku, Tokyo				

Modern Mid-rise Apt. in Kodenmacho, near Nihombashi area

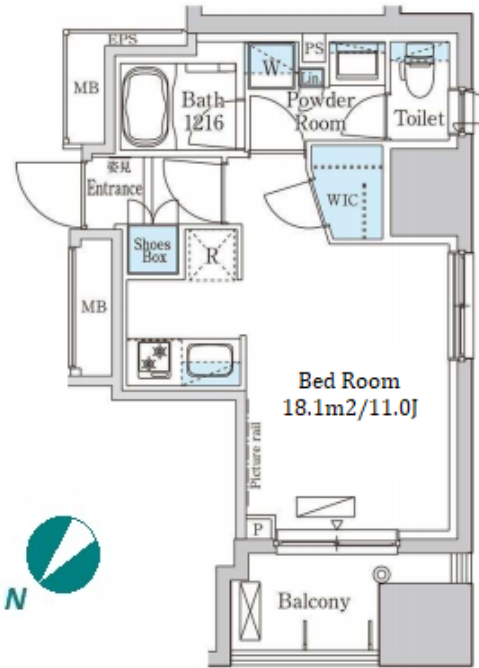

Lease Conditions		
LAYOUT	Studio	
SIZE	31.28 m ² /336.69 ft ²	
RENT	JPY 154,000 / month	
Management Fee	JPY11,000/month	
Deposit	2 months	Key Money -
Lease Term	Standard lease for 24 months	
Available	Now	
Renewal Fee	1 month	
Agent Fee	1 month + tax	
Other Info	Key Replacement Fee : JPY15,000 Tax not included / Guarantor Company : TBC / No Key Money / Auto lock / Air-Con / Separated Toilet / Balcony / Penalty Fee for Early Cancellation / Musical Instrument Negotiable / CS/CATV / Flooring / Bathroom dryer / WIC	

Building Information			
Completion	Jun, 2016	Earthquake Resistance	New
Structure	RC, 14 floors above		
Car Parking	-		
Bicycle Parking	JPY300 + tax / month		
Music Instrument	Negotiable	Pet	Allowed
Facilities	Motorcycle Parking (TBC) / Delivery box / Elevator / Newly-built (~7 y/o)		

Remarks
Renters Insurance : Required / Pet:additional deposit (1 month) / Pet : a small dog or a cat

*The actual Layout & Size may differ slightly from this floor plans & pictures.



HOUSEREP TOKYO INC.
ハウスレップトーキョー株式会社

#301, 1-4-15, Hiroo, Shibuya-ku, Tokyo 150-0012, Japan
+81 (0)3 6427 5860 inquiry@housserep-tokyo.com

Transaction Type : Intermediate
Agent Fee : 1 month + tax

Website : www.housserep-tokyo.com

