

Property Name	LA TOUR SHINJUKU ANNEX	Unit No.	TYPE	Access	Nishishinnjukugochoume Station on Oedo Line (7 min) Nishishinnjuku Station on Marunouchi Line (8 min) Shinnjuku Station on JR Yamanote Line (13 min)
		817	Apt.		
Address	6-18-1, Nishishinjuku, Shinjuku-Ku, Tokyo				

New luxury apartment w/ free shuttle bus service to Shinjuku stn

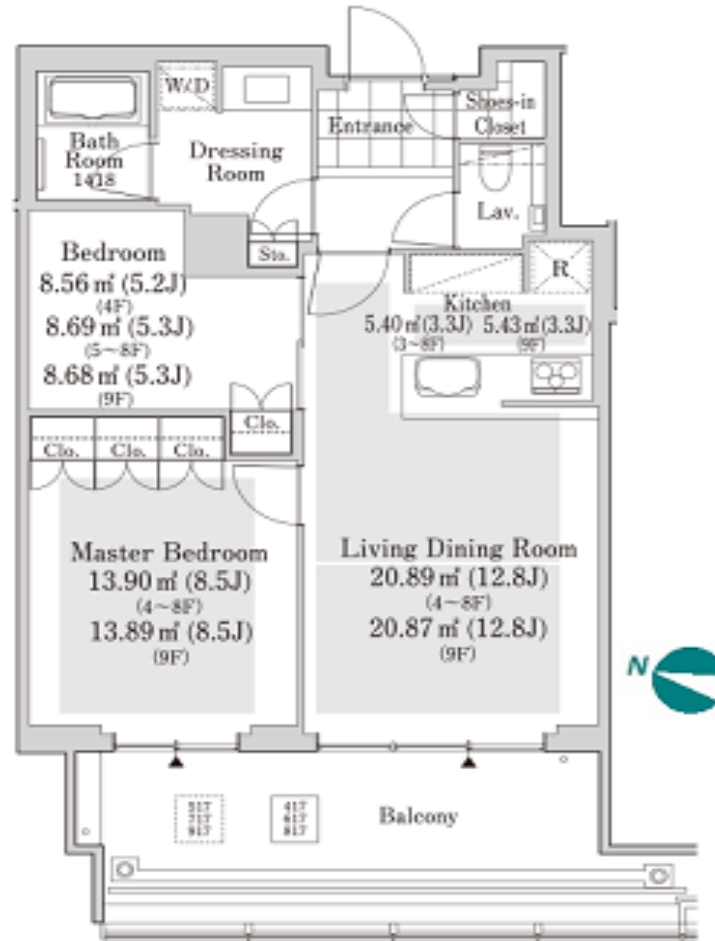

*The actual Layout & Size may differ slightly from this floor plans & pictures.

Lease Conditions

LAYOUT	2 BR	
SIZE	67.35 m²/724.94 ft²	
RENT	JPY 443,000 / month	
Management Fee	-	
Deposit	2 months	Key Money -
Lease Term	Fixed term lease for 36 months	
Available	Early, Sep, 2024	
Renewal Fee	-	
Agent Fee	1 month + tax	
Other Info	Depreciation : 1 month / No Key Money / Auto lock / Air-Con / Separated Toilet / Balcony / Internet Included / Penalty Fee for Early Cancellation / Flooring / Floor Heating / Dishwasher / Bathroom dryer	

Building Information

Completion	Aug, 2019	Earthquake Resistance	New
Structure	SC, 33 floors above and 2 basement floors		
Car Parking	extra charge		
Bicycle Parking	JPY500/ month		
Music Instrument	-	Pet	Negotiable
Facilities	Motorcycle Parking (extra charge) / Near Large Parks / Front desk / Concierge / Delivery box / Elevator / Security / High-rise		

Remarks



HOUSEREP TOKYO INC.

ハウスレップトーキョー株式会社

#301, 1-4-15, Hiroo, Shibuya-ku, Tokyo 150-0012, Japan

+81 (0)3 6427 5860

inquiry@housserrep-tokyo.com

Transaction Type : Intermediate

Agent Fee : 1 month + tax

Website : www.housserrep-tokyo.com

