

Property Name	PARK AXIS KODENMACHO	Unit No.	TYPE	Access	Kodenmachou Station on Hibiya Line (3 min) Bakurochou Station on JR Sobu Line (5 min) Kannda Station on JR Yamanote Line (10 min)
		801	Apt.		
Address	1-7-8, Iwamotocho, Chiyoda-Ku, Tokyo				

Modern Mid-rise Apt. in Kodenmacho, near Nihombashi area

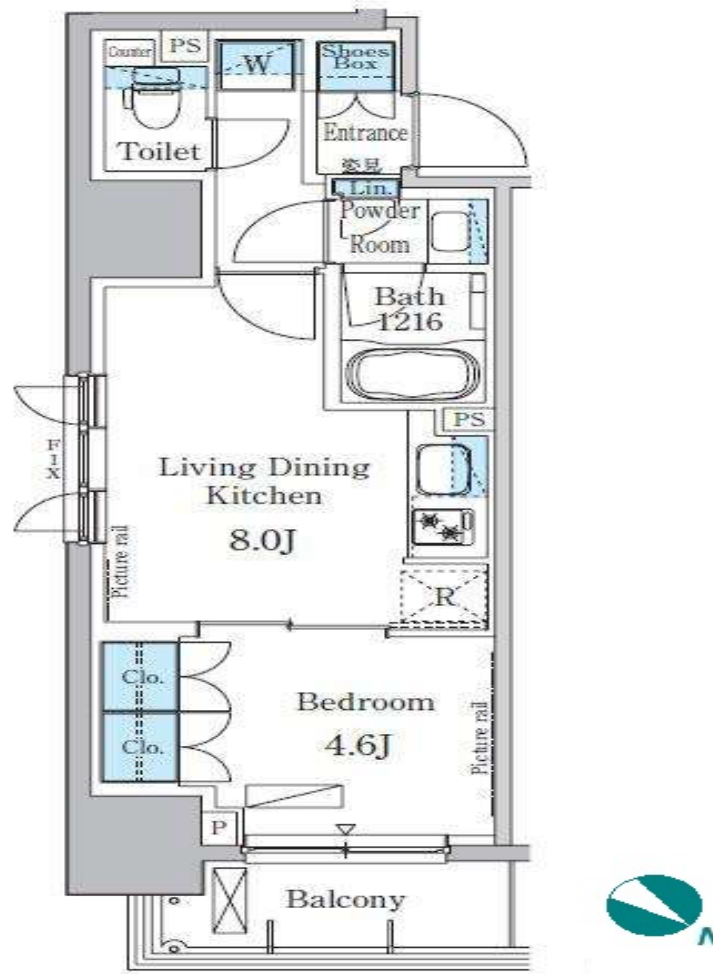

*The actual Layout & Size may differ slightly from this floor plans & pictures.

Lease Conditions	
LAYOUT	1 BR
SIZE	34.54 m ² /371.78 ft ²
RENT	JPY 169,000 / month
Management Fee	JPY13,000/month
Deposit	2 months
Key Money	1 month
Lease Term	Standard lease for 24 months
Available	End, Oct, 2024
Renewal Fee	1 month
Agent Fee	1 month + tax
Other Info	Key Replacement Fee : JPY15,000 Tax not included / Guarantor Company : TBC / Auto lock / Air-Con / Separated Toilet / Balcony / Musical Instrument Negotiable / CS/CATV / Flooring / Bathroom dryer

Building Information	
Completion	Jun, 2016
Earthquake Resistance	New
Structure	RC, 14 floors above
Car Parking	-
Bicycle Parking	JPY300 + tax / month
Music Instrument	Negotiable
Pet	Allowed
Facilities	Motorcycle Parking (TBC) / Delivery box / Elevator / Newly-built (~7 y/o)

Remarks
Pet:additional deposit (1 month) / Pet : a small dog or a cat



HOUSEREP TOKYO INC.

ハウスレップトーキョー株式会社

#301, 1-4-15, Hiroo, Shibuya-ku, Tokyo 150-0012, Japan

+81 (0)3 6427 5860

inquiry@housserep-tokyo.com

Transaction Type : Intermediate

Agent Fee : 1 month + tax

Website : www.housserep-tokyo.com

