

Property Name	LA TOUR SHINJUKU ANNEX	Unit No.	TYPE	Access	Nishishinnjukugochoume Station on Oedo Line (7 min) Nishishinnjuku Station on Marunouchi Line (8 min) Shinnjuku Station on JR Yamanote Line (13 min)
		516	Apt.		
Address	6-18-1, Nishishinjuku, Shinjuku-Ku, Tokyo				

New luxury apartment w/ free shuttle bus service to Shinjuku stn

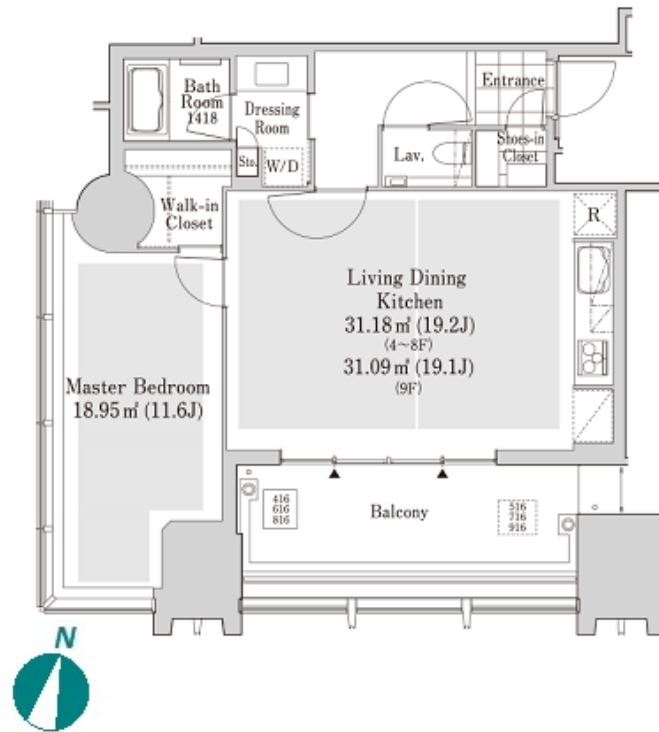

Lease Conditions	
LAYOUT	1 BR
SIZE	70.04 m²/753.9 ft²
RENT	JPY 448,000 / month
Management Fee	-
Deposit	2 months
Key Money	-
Lease Term	Fixed term lease for 36 months
Available	Negotiable
Renewal Fee	-
Agent Fee	1 month + tax
Other Info	Depreciation : 1 month / No Key Money / Auto lock / Air-Con / Separated Toilet / Balcony / Internet Included / Penalty Fee for Early Cancellation / Flooring / Floor Heating / Dishwasher / WIC

Building Information	
Completion	Aug, 2019
Earthquake Resistance	New
Structure	SC, 33 floors above and 2 basement floors
Car Parking	extra charge
Bicycle Parking	JPY500/ month
Music Instrument	-
Pet	Negotiable
Facilities	Motorcycle Parking (extra charge) / Near Large Parks / Front desk / Concierge / Delivery box / Elevator / Security / High-rise

Remarks

*The actual Layout & Size may differ slightly from this floor plans & pictures.



HOUSEREP TOKYO INC.

ハウスレップトーキョー株式会社

#301, 1-4-15, Hiroo, Shibuya-ku, Tokyo 150-0012, Japan

+81 (0)3 6427 5860

inquiry@housserrep-tokyo.com

Transaction Type : Intermediate

Agent Fee : 1 month + tax

Website : www.housserrep-tokyo.com

