

Property Name	ASAHI MANSION GOTANDA	Unit No.	TYPE	Access	Gotanda Station on JR Yamanote Line (5 min) Gotanda Station on Toei Asakusa Line (5 min) Gotanda Station on Tokyu Ikegami Line (5 min)
		1404	Apt.		
Address	2-28-4, Nishigotanda, Shinagawa-Ku, Tokyo				

High-rise Apt. in Gotanda, easy access to Ebisu, Shibuya, Shinjuku

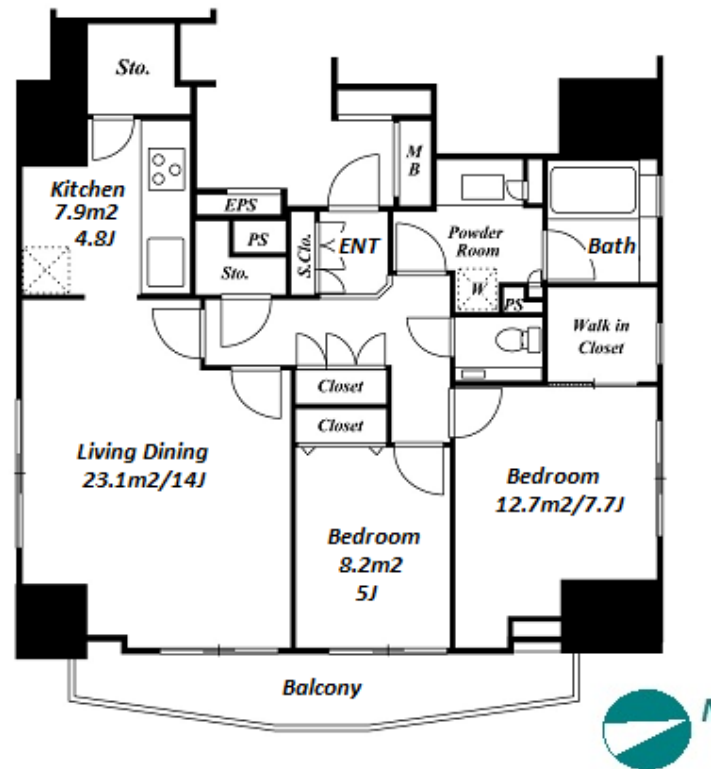

Lease Conditions	
LAYOUT	2 BR
SIZE	80.02 m ² /861.32 ft ²
RENT	JPY 345,000 / month
Management Fee	JPY17,000/month
Deposit	2 months
Key Money	-
Lease Term	Fixed term lease for 36 months
Available	Now
Renewal Fee	-
Agent Fee	1 month + tax
Other Info	Guarantor Company : TBC / No Key Money / Auto lock / Air-Con / Separated Toilet / Balcony / Penalty Fee for Early Cancellation / Musical Instrument Negotiable / Nice Views / Flooring / Floor Heating / Bathroom dryer / WIC / Corner Unit

Building Information			
Completion	Apr, 2013	Earthquake Resistance	New
Structure	RC, 18 floors above		
Car Parking	TBC		
Bicycle Parking	TBC		
Music Instrument	Negotiable	Pet	N/A
Facilities	Within 20 min to Roppongi by train / Within 20 min to Tokyo station by car / Near Large Parks / Delivery box / Elevator / High-rise		

*The actual Layout & Size may differ slightly from this floor plans & pictures.



HOUSEREP TOKYO INC.

ハウズレップトーキョー株式会社

#301, 1-4-15, Hiroo, Shibuya-ku, Tokyo 150-0012, Japan

+81 (0)3 6427 5860

inquiry@housserrep-tokyo.com

Transaction Type : Intermediate

Agent Fee : 1 month + tax

Website : www.housserrep-tokyo.com



Remarks
Renters Insurance : Required