

Property Name	PARK AXIS TORANOMON	Unit No.	TYPE	Access	Toranomom Hills Station on Ginza Line (6 min) Onarimomn Station on Mita Line (7 min) Toranomom Hills Station on Hibiya Line (10 min)
		1302	Apt.		
Address	3-14-1, Nishishimbashi, Minato-Ku, Tokyo				

Modern Mid-rise Apartment near Shiba Park

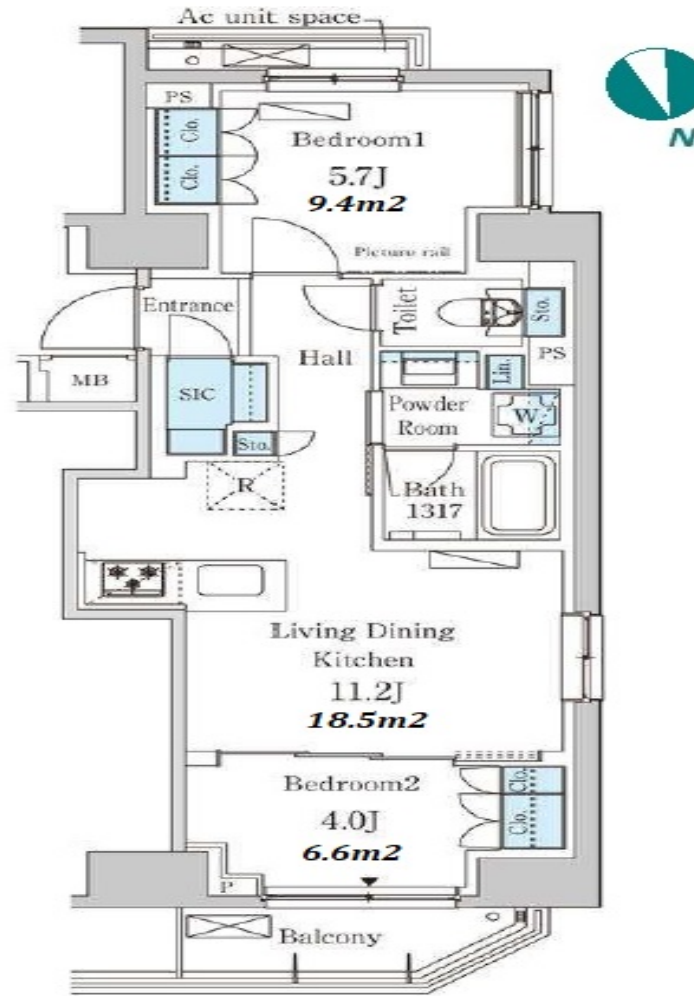

*The actual Layout & Size may differ slightly from this floor plans & pictures.

Lease Conditions	
LAYOUT	2 BR
SIZE	50.46 m ² /543.14 ft ²
RENT	JPY 315,000 / month
Management Fee	JPY15,000/month
Deposit	2 months
Key Money	1 month
Lease Term	Standard lease for 24 months
Available	End, Sep, 2024
Renewal Fee	1 month
Agent Fee	1 month + tax
Other Info	Key Replacement Fee : JPY20,000 Tax not included / Guarantor Company : TBC / Auto lock / Air-Con / Separated Toilet / Balcony / Musical Instrument Negotiable / Flooring / Bathroom dryer

Building Information	
Completion	Feb, 2019
Earthquake Resistance	New
Structure	RC, 14 floors above
Car Parking	(Included)
Bicycle Parking	TBC
Music Instrument	Negotiable
Pet	Negotiable
Facilities	Motorcycle Parking (TBC) / Trunk Room (TBC) / Within 20 min to Roppongi by train / Within 20 min to Tokyo station by car / Near Large Parks / Delivery box / Elevator

Remarks	
Renters Insurance : Required / Parking : Sticker fee: JPT1,000+tax / Pet: Additional 1mo deposit / Room cleaning fee: JPY60,560+tax (when moving out) / AC cleaning fee: JPY10,000+tax per AC (when moving out)	



HOUSEREP TOKYO INC.

ハウズレップトーキョー株式会社

#301, 1-4-15, Hiroo, Shibuya-ku, Tokyo 150-0012, Japan

+81 (0)3 6427 5860

inquiry@housserrep-tokyo.com

Transaction Type : Intermediate

Agent Fee : 1 month + tax

Website : www.housserrep-tokyo.com

