

Property Name	APARTMENTS MOTOAZABU UCHIDAZAKA	Unit No.	TYPE	Access	Ropponngi Station on Hibiya Line (8 min) Azabujuban Station on Oedo Line (9 min)
		602	Apt.		
Address	3-8-6, Motoazabu, Minato-Ku, Tokyo				

Stylish Apt. in Motoazabu, just next to "Roppongi Hills", near "Azabujuban"

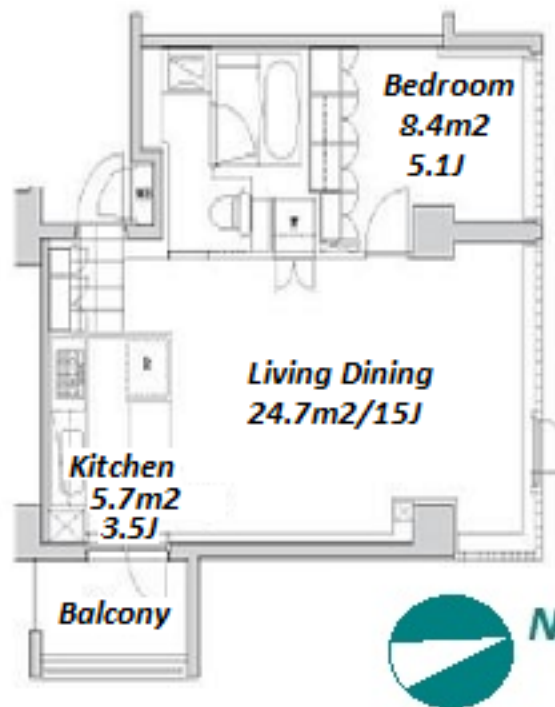
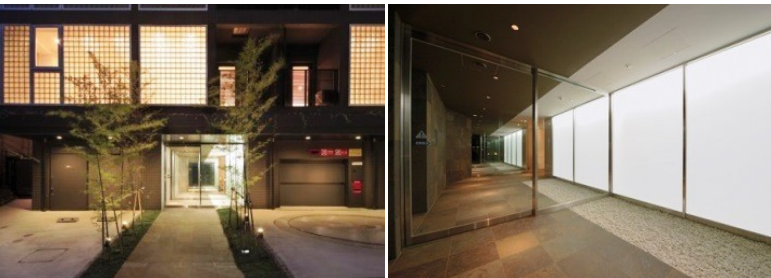

Lease Conditions		
LAYOUT	1 BR	
SIZE	54.64 m <sup>2</sup> /588.14 ft <sup>2</sup>	
RENT	JPY 277,000 / month	
Management Fee	JPY12,000/month	
Deposit	2 months	Key Money 1 month
Lease Term	Fixed term lease for 24 months	
Available	Mid, Jul, 2024	
Renewal Fee	-	
Agent Fee	1 month + tax	
Other Info	Key Replacement Fee : JPY20,000 Tax not included / Guarantor Company : TBC / Auto lock / Air-Con / Separated Toilet / Balcony / Flooring	

Building Information		
Completion	Oct, 2006	Earthquake Resistance New
Structure	RC, 7 floors above and 1 basement floors	
Car Parking	extra charge	
Bicycle Parking	( Included )	
Music Instrument	-	Pet -
Facilities	Motorcycle Parking (TBC) / Janitor / Delivery box / Elevator / Security / 24h Garbage Drop-off	

Remarks
Renters Insurance : Required

\*The actual Layout & Size may differ slightly from this floor plans & pictures.



HOUSEREP TOKYO INC.

ハウスレップトーキョー株式会社

#301, 1-4-15, Hiroo, Shibuya-ku, Tokyo 150-0012, Japan

+81 (0)3 6427 5860

inquiry@housserep-tokyo.com

Transaction Type : Intermediate

Agent Fee : 1 month + tax

Website : www.housserep-tokyo.com

