

Property Name	PARK CUBE GAKUGEIDAIGAKU	Unit No.	105	TYPE	Apt.	Access	Gakugeidaigaku Station on Toyoko Line (9 min) Yuutennji Station on Toyoko Line (13 min)
Address	3-13-23, Gohongi, Meguro-Ku, Tokyo						

Low Rise Apt. in Gakugeidaigaku, in Calm Residential Area

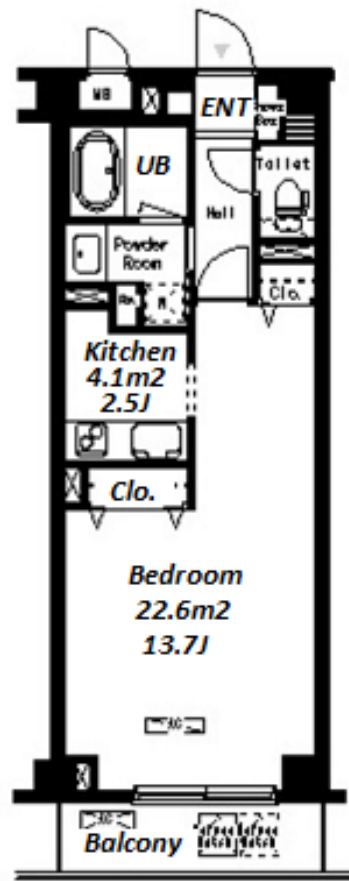
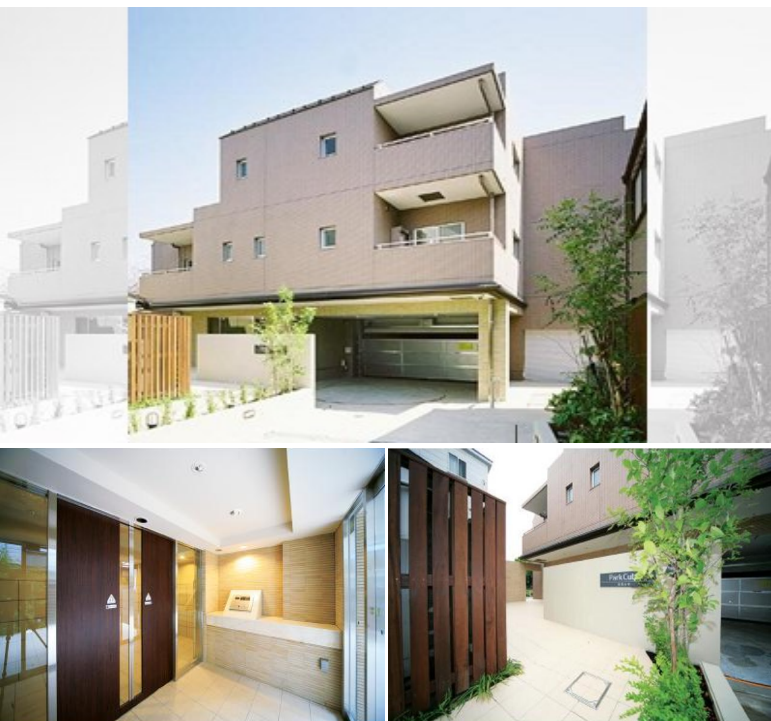

\*The actual Layout & Size may differ slightly from this floor plans & pictures.

Lease Conditions			
LAYOUT	Studio		
SIZE	40.84 m²/439.59 ft²		
RENT	JPY 167,000 / month		
Management Fee	JPY6,000/month		
Deposit	2 months	Key Money	1 month
Lease Term	Standard lease for 24 months		
Available	Mid, Jul, 2024		
Renewal Fee	1 month		
Agent Fee	1 month + tax		
Other Info	Key Replacement Fee : JPY15,000 Tax not included / Guarantor Company : TBC / Auto lock / Air-Con / Separated Toilet / Balcony / Penalty Fee for Early Cancellation / Musical Instrument Negotiable / CS/CATV / Bathroom dryer		

Building Information			
Completion	Mar, 2008	Earthquake Resistance	New
Structure	RC, 3 floors above		
Car Parking	JPY32,000 + tax / month		
Bicycle Parking	for 1 space ( Included )		
Musical Instrument	Negotiable	Pet	Allowed
Facilities	Motorcycle Parking (JPY3,000 + tax / month) / Delivery box / Elevator		

Remarks
Renters Insurance : Required / Bicycle parking : Registration fee: JPY.2,000+tax / Pet:additional deposit ( 1 month ) / Pet : a small dog or up to two cats



HOUSEREP TOKYO INC.

ハウスレップトーキョー株式会社

#301, 1-4-15, Hiroo, Shibuya-ku, Tokyo 150-0012, Japan

+81 (0)3 6427 5860

inquiry@housserep-tokyo.com

Transaction Type : Intermediate

Agent Fee : 1 month + tax

Website : www.housserep-tokyo.com

