

Property Name	LA TOUR IIDABASHI	Unit No.	TYPE	Access	Iidabashi Station on JR Chuo Line Rapid Service (6 min) Iidabashi Station on Yurakucho Line (6 min) Kourakuenn Station on Namboku Line (9 min)
		901	Apt.		
Address	2-6-1, Koraku, Bunkyo-Ku, Tokyo				

## Luxury Tower Residence in Iidabashi, near "Kagurazaka" Shopping Streets

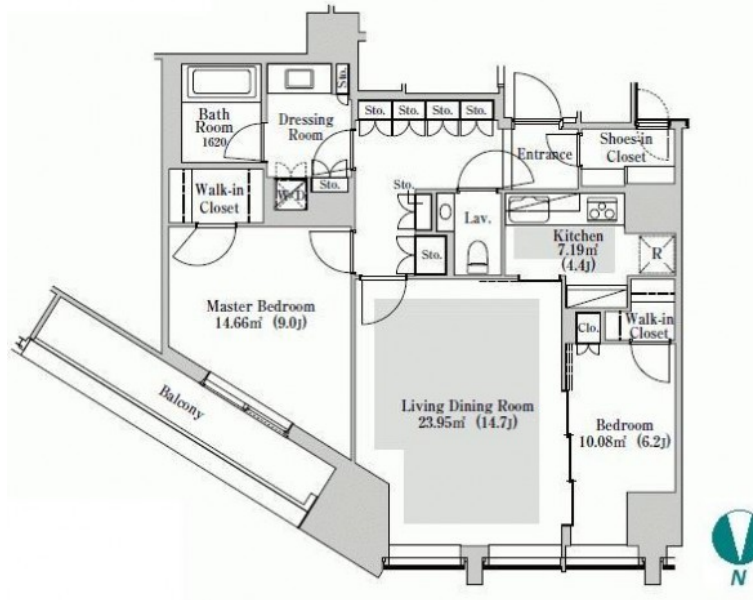

### Lease Conditions

LAYOUT	2 BR	
SIZE	87.1 m²/937.53 ft²	
RENT	JPY 590,000 / month	
Management Fee	-	
Deposit	2 months	Key Money -
Lease Term	Fixed term lease for 36 months	
Available	Negotiable	
Renewal Fee	-	
Agent Fee	1 month + tax	
Other Info	Depreciation : 1 month / No Key Money / Auto lock / Air-Con / Separated Toilet / Balcony / Penalty Fee for Early Cancellation / Floor Heating / WIC	

### Building Information

Completion	Apr, 2010	Earthquake Resistance	New
Structure	RC, 34 floors above		
Car Parking	JPY40,000 ~ 65,000/ month		
Bicycle Parking	TBC		
Music Instrument	-	Pet	Negotiable
Facilities	Motorcycle Parking (TBC) / Trunk Room (extra charge) / Gym (( Included )) / Within 20 min to Tokyo station by car / Near Large Parks / French Community / Front desk / Concierge / Delivery box / Elevator / High-rise		

### Remarks

--

\*The actual Layout & Size may differ slightly from this floor plans & pictures.



# HOUSEREP TOKYO INC.

ハウスレップトーキョー株式会社

#301, 1-4-15, Hiroo, Shibuya-ku, Tokyo 150-0012, Japan

+81 (0)3 6427 5860

inquiry@housserrep-tokyo.com

Transaction Type : Intermediate

Agent Fee : 1 month + tax

Website : www.housserrep-tokyo.com

