

Property Name	COMFORIA MINAMIAOYAMA	Unit No.	TYPE	Access	Gaiennmae Station on Ginza Line (5 min) Omotesanndou Station on Hanzomon Line (11 min)
		604	Apt.		
Address	4-1-12, Minamiaoyama, Minato-Ku, Tokyo				

Stylish mid-rise in Minamiaoyama

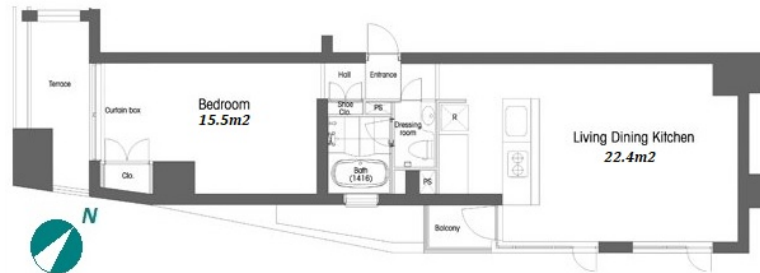

Lease Conditions	
LAYOUT	1 BR
SIZE	55.49 m²/597.28 ft²
RENT	JPY 294,000 / month
Management Fee	JPY15,000/month
Deposit	2 months
Key Money	-
Lease Term	Standard lease for 24 months
Available	End, Oct, 2024
Renewal Fee	1 month
Agent Fee	1 month + tax
Other Info	Key Replacement Fee : JPY30,000 Tax not included / No Key Money / Auto lock / Air-Con / Separated Toilet / Balcony / Penalty Fee for Early Cancellation / Garden/Terrace / Flooring

Building Information			
Completion	Oct, 2003	Earthquake Resistance	New
Structure	RC, 9 floors above		
Car Parking	N/A		
Bicycle Parking	TBC		
Music Instrument	-	Pet	Negotiable
Facilities	Within 20 min walk to Roppongi / Near Large Parks		

Remarks
Renters Insurance : Required / Room cleaning fee: JPY48,000+tax (when moving out) / AC cleaning fee: JPY50,000+tax (when moving out)

*The actual Layout & Size may differ slightly from this floor plans & pictures.



HOUSEREP TOKYO INC.

ハウズレップトーキョー株式会社

#301, 1-4-15, Hiroo, Shibuya-ku, Tokyo 150-0012, Japan

+81 (0)3 6427 5860

inquiry@housserep-tokyo.com

Transaction Type : Intermediate

Agent Fee : 1 month + tax

Website : www.housserep-tokyo.com

